

YOU ARE A GUIDE TO THE
WORLD OF LUXURY

AQUA ARC

BY BNW DEVELOPMENTS

AL MARJAN ISLAND





DESIGN PHILOSOPHY

BY THE ARCHITECT

Influenced by the breathtaking landscape of Ras Al Khaimah and the majestic Jais Mountain, the architectural concept emulates the organic forms of natural peaks and valleys, seamlessly integrating two interconnected blocks to sculpt a serene valley-like oasis. The podium roof, reminiscent of mountain caverns, boasts enchanting apertures facilitating cascading water installations and al fresco pursuits. Reflecting the undulating rhythm of ocean waves, the balconies harmonize the essence of mountain grandeur with the allure of the sea. Each building boasts a double-height lobby seamlessly integrated with lush landscaping, fostering a sense of harmony and tranquillity. The pinnacle of luxury awaits at penthouses with 360 views.

YOUR ULTIMATE LUXURY ESCAPE

Experience the pinnacle of luxury at Aqua Arc, situated in the emerging vibrant hub of Al Marjan Island in Ras Al Khaimah. Aqua Arc is a one-of-a-kind, water-inspired architectural masterpiece, that redefines luxury living and ultimate leisure, offering an unmatched experience amidst serene landscapes and azure waters.

This exquisite sanctuary exemplifies impeccable design and it's designed to elevate your lifestyle, ensuring an extraordinary journey towards timeless elegance and sophistication.







A SERENE OASIS

AWAITS YOUR ARRIVAL

Embark on a journey where coastal bliss meets contemporary luxury at Aqua Arc on Al Marjan Island. Here, modern sophistication harmonizes with the tranquil sea melody. Awaken to waves caressing the shore, enjoying panoramic azure vistas from your exclusive balcony sanctuary. Discover refined coastal living at its finest, where every detail ensures elegance and tranquillity, offering an exquisite lifestyle experience.



Beach Access



Walking Trails



BBQ Area





THE PINNACLE OF LUXURY LIVING





UNPARALLELED

ELEGANCE

Aqua Arc is a sanctuary where luxury meets tranquillity, and every detail is crafted with intention and purpose. Inspired by the timeless allure of the sea, the residences boast awe-inspiring wavelike balconies, echoing the elegance of coastal living. Premium units feature meticulously designed private pools on expansive terraces, offering exclusive retreats with sweeping vistas of azure waters. Aqua Arc redefines the art of seaside living, where every moment is an ode to the pinnacle of opulence.



Seaside View



Amphitheatre



Pool on the terrace*





WHERE DREAMS

RESIDE

① Al Marjan Island Beach Access

② Al Marjan Island Boulevard

③ Al Marjan Island Resort & Spa

④ Al Hamra Mall

⑤ Al Hamra Golf Club

⑥ Saudi German Hospital

⑦ Wynn Resorts

⑧ Rixos Bab-al-Bahr Resort

⑨ Hampton by Hilton Hotel

⑩ DoubleTree by Hilton Resort & Spa

⑪ Radisson Resort

⑫ Mövenpick Resort





A PARADISE CRAFTED TO PERFECTION

Experience the pinnacle of coastal living at Aqua Arc, an unparalleled masterpiece where the tranquility of coastal living meets the vibrancy of urban sophistication, creating an oasis of serenity amidst the dynamic energy of the Emirates. With its strategic location and unmatched attention to detail, Aqua Arc offers a rare opportunity to embrace the quintessential luxury lifestyle in one of the most coveted destinations in the world.



Platinum Gym



Kids Splash Pad



Steam & Sauna





FIRST-CLASS
FACILITIES





EXQUISITE SOPHISTICATION

Every element of these extraordinary residences is meticulously curated to ensure a seamless blend of timeless quality and contemporary allure.

From the moment you step inside, you are greeted by impeccable craftsmanship, luxurious finishes, and spacious layouts designed to exceed the most discerning standards. Immerse yourself in a world of unparalleled refinement and comfort, where every detail has been thoughtfully considered to elevate your living experience.



Panoramic View



Ultra Luxury Living



Attention to Detail





LAVISH INDULGENCE
UNLOCKED



YOUR GATEWAY TO PARADISE

Aqua Arc epitomizes the essence of refined luxury amidst the tranquil shores of Al Marjan Island, Ras Al Khaimah. Every detail, meticulously crafted from sweeping architectural lines to bespoke amenities, exudes unparalleled sophistication and opulence. Set against the breathtaking backdrop of Ras Al Khaimah's pristine coastline, Aqua Arc stands as a beacon of timeless elegance, inviting guests to immerse themselves in a world where luxury transcends boundaries.



Rooftop Pool



Recreational Area



Luxurious Landscaping



ANKUR AGGARWAL

Chairman & Founder

Ankur Aggarwal, a chartered accountant, the visionary founder of BnW Developments, has swiftly positioned the company as a leader in luxury real estate with its prestigious mixed-use projects in prime locations like Ras Al Khaimah and Dubai. With AUM exceeding 15 billion AED, these projects showcase Ankur's commitment to excellence and innovation. Each development merges cutting-edge design and quality with exceptional luxury, setting new industry benchmarks.



VIVEK ANAND OBEROI

Managing Director & Co-Founder

Vivek Anand Oberoi, Managing Director & Co-Founder at BnW, is celebrated for his multifaceted career in Indian cinema, entrepreneurship, and philanthropy. He has starred in 47 films spanning seven languages, earning an Emmy nomination for "Inside Edge." Recognized by Forbes as one of the Top 40 global philanthropists, Vivek integrates altruism into his business strategies. Through his family office, he oversees multiple companies, ensuring alignment with ethical and sustainable principles.

UNIT PLANS

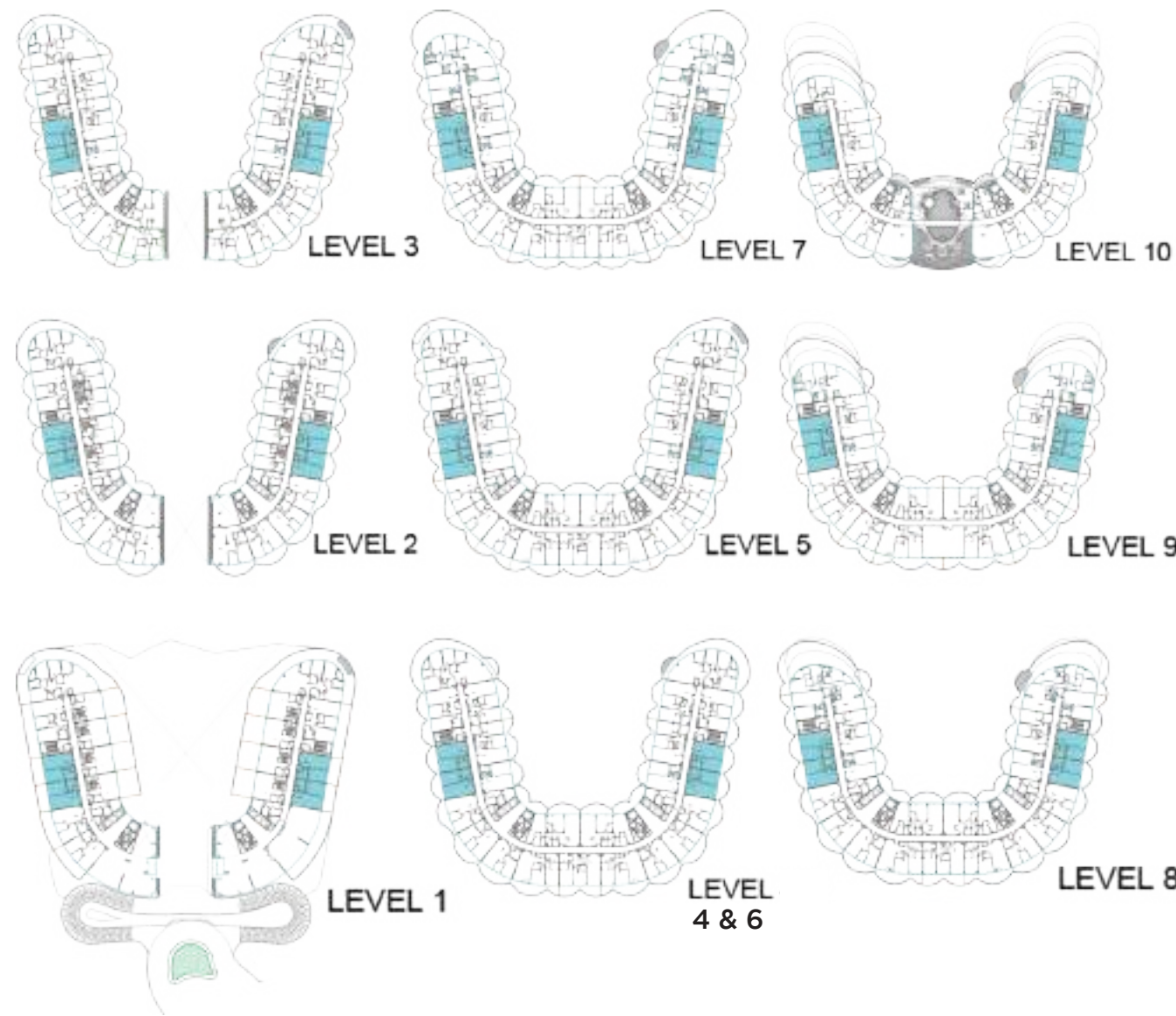

1 BEDROOM

TYPE A

| | | |
|---|----------|--------------|
| 1 | KITCHEN | 3m x 2.9m |
| 2 | LIVING | 6.6m x 4.0m |
| 3 | BALCONY | MIN. 1m wide |
| 4 | BEDROOM | 3.8m x 5.4m |
| 5 | BATH | 2.9m x 2.9m |
| 6 | PWD ROOM | 1.8m x 1.8m |
| 7 | LAUNDRY | 0.9m x 1.6m |

| | From | To |
|--------------|-----------------|-----------------|
| Suite Area | 850.78sq. ft. | 861.22sq. ft. |
| Balcony Area | 241.33 sq. ft. | 310.11 sq. ft. |
| Total Area | 1092.11 sq. ft. | 1171.33 sq. ft. |

*All images used for illustrative purposes only and do not represent the actual size, feature specificatons, fitting, and furnishing. The developer reserves the right to make revision / alterations, at its absolute discretion, without any liability whatsoever.

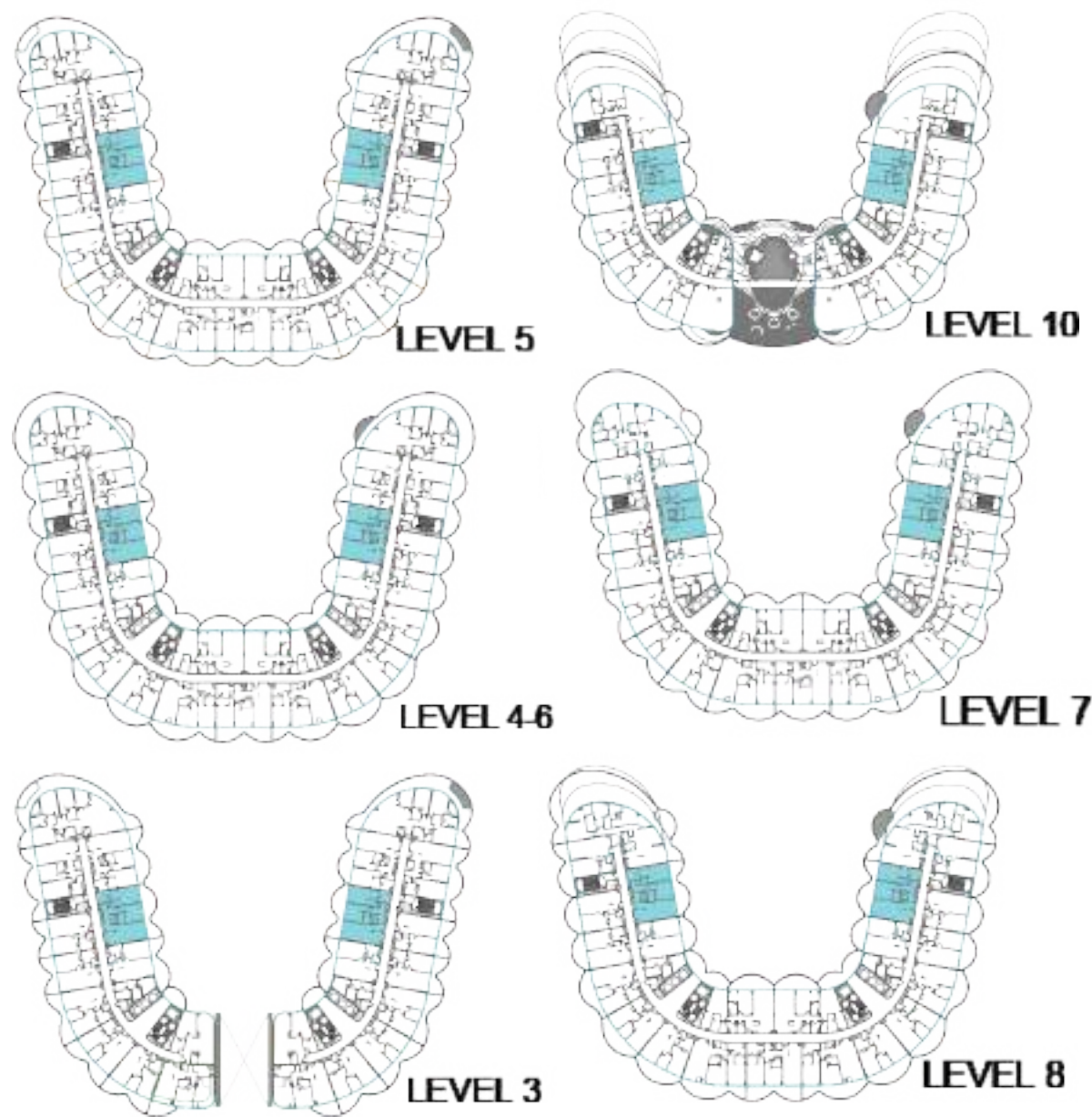

2 BEDROOM

TYPE C

| | | |
|---|----------|---------------|
| 1 | KITCHEN | 2.9m x 3.1m |
| 2 | LIVING | 4.3m x 6.5m |
| 3 | BALCONY | MIN 1.6m wide |
| 4 | BEDROOM | 4.2m x 3.5m |
| 5 | BATH | 2.6m x 1.6m |
| 6 | BEDROOM | 3.8m x 4.7m |
| 7 | BATH | 2.5m x 2.9m |
| 8 | PWD ROOM | 1.9m x 0.9m |
| 9 | LAUNDRY | 1.2m x 1.1m |

| | From | To |
|--------------|-----------------|----------------|
| Suite Area | 1267.34 sq. ft. | 1281.34sq. ft. |
| Balcony Area | 343.48 sq. ft. | 350.47sq. ft. |
| Total Area | 1610.82sq. ft. | 1631.81sq. ft. |

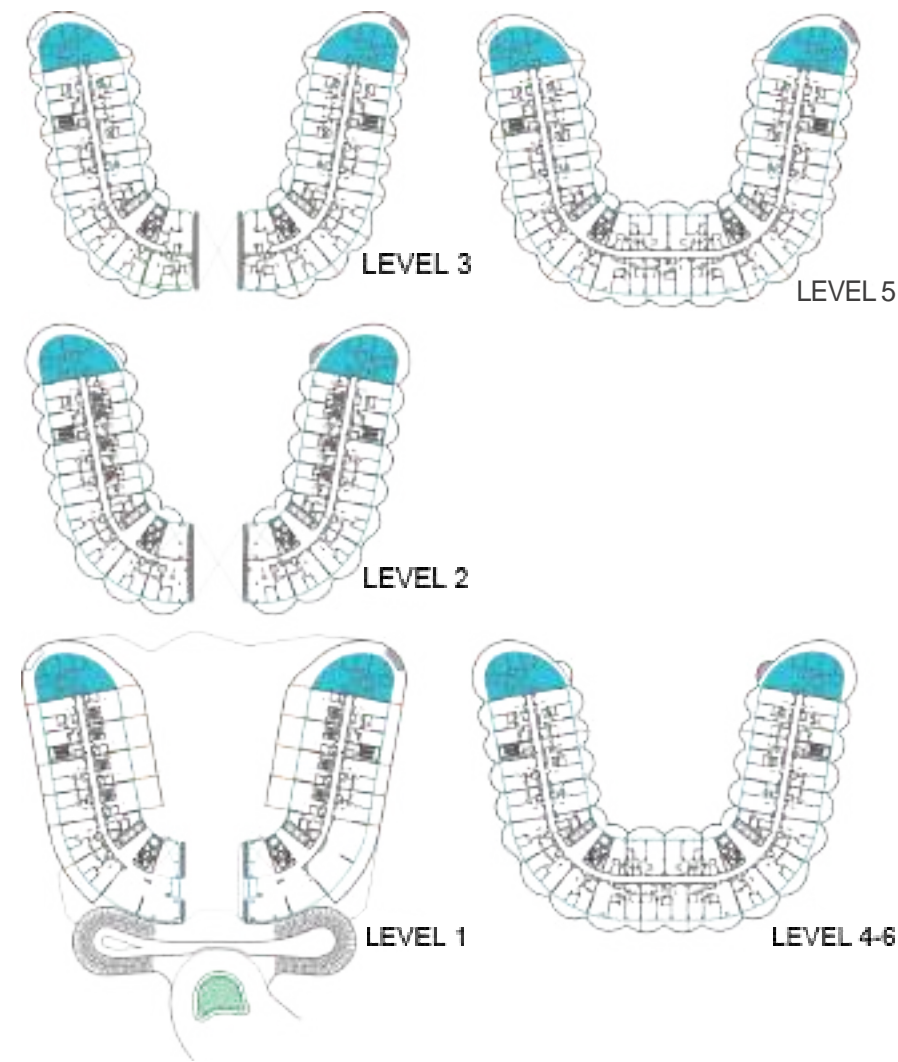

| | From | To |
|--------------|-----------------|-----------------|
| Suite Area | 2135.02 sq. ft. | 2135.56 sq. ft. |
| Balcony Area | 1140.87 sq. ft. | 1644.19 sq. ft. |
| Total Area | 3275.89 sq. ft. | 3779.75 sq. ft. |

3 BEDROOM

TYPE A

| | | |
|----|--------------|---------------|
| 1 | KITCHEN | 3.6m x 2.5m |
| 2 | LIVING | 8m x 9.5m |
| 3 | BALCONY | MIN.1.2m wide |
| 4 | STUDY | 3.5m x 4.2m |
| 5 | BEDROOM | 3.4m x 4.2m |
| 6 | BATH | 2.2m x 2.7m |
| 7 | PWD ROOM | 1.6m x 2.1m |
| 8 | BEDROOM | 3.7m x 3.7m |
| 9 | BATH | 2.6m x 3.0m |
| 10 | BATH | 2.5m x 3.4m |
| 11 | BEDROOM | 5.0m x 3.9m |
| 12 | STORE | 2.4m x 2.8m |
| 13 | LAUNDRY | 1.1m x 0.9m |
| 14 | BATH | 1.9m x 1.6m |
| 15 | PRIVATE POOL | |

*All images used for illustrative purposes only and do not represent the actual size, feature specificatons, fitting, and furnishing. The developer reserves the right to make revision / alterations, at its absolute discretion, without any liability whatsoever.

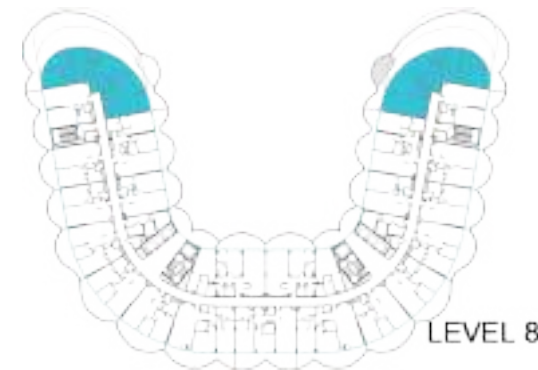

| | From | To |
|--------------|-----------------|-----------------|
| Suite Area | 2081.09 sq. ft. | 2082.31 sq. ft. |
| Balcony Area | 2353.53 sq. ft. | 2353.31 sq. ft. |
| Total Area | 4434.62 sq. ft. | 4434.62 sq. ft. |

3 BEDROOM

TYPE C

| | | |
|----|--------------|-----------------|
| 1 | KITCHEN | 4.2m x 2.4m |
| 2 | DINING | 4.7m x 3.9m |
| 3 | LIVING | 6m x 4m |
| 4 | LAUNDRY | 1.2m x 1m |
| 5 | PWD ROOM | 2.3m x 1.5m |
| 6 | BEDROOM | 6.7m x 4.4m |
| 7 | BATH | 1.2m x 2.5m |
| 8 | BATH | 3.6m x 2.9m |
| 9 | BEDROOM | 3.5m x 3.1m |
| 10 | BATH | 1.6m x 2.9m |
| 11 | BEDROOM | 4.7m x 7.2m |
| 12 | BATH | 2m x 3.9m |
| 13 | STORE | 1.7m x 2.5m |
| 14 | BALCONY | MIN. 1.54m wide |
| 15 | PRIVATE POOL | |



PENTHOUSE

| | | | | | |
|---|----------|--------------|----|--------------|----------------|
| 1 | KITCHEN | 6.3m x 5.2m | 10 | BEDROOM | 4.05m x 6.7m |
| 2 | LIVING | 16.3m x 7.4m | 11 | BATH | 2.4m x 2.7m |
| 3 | PWD ROOM | 1.6m x 1.2m | 12 | BEDROOM | 10.1m x 6m |
| 4 | BATH | 2.8m x 1.5m | 13 | BATH | 3.4m x 5.3m |
| 5 | STUDY | 3.6m x 5.3m | 14 | BEDROOM | 5.4m x 4.2m |
| 6 | BEDROOM | 4.2m x 3.1m | 15 | BATH | 2.5m x 3.4m |
| 7 | BATH | 2.3m x 2.3m | 16 | BALCONY | MIN. 1.2m wide |
| 8 | BEDROOM | 4m x 6m | 17 | LAUNDRY | 1m x 1.2m |
| 9 | BATH | 3m x 2.4m | 18 | PRIVATE POOL | |

| | From | To |
|--------------|-----------------|-----------------|
| Suite Area | 5547.72 sq. ft. | 5549.44sq. ft. |
| Balcony Area | 3111.42 sq. ft. | 3111.52 sq. ft. |
| Total Area | 8659.14 sq. ft. | 8660.97 sq. ft. |

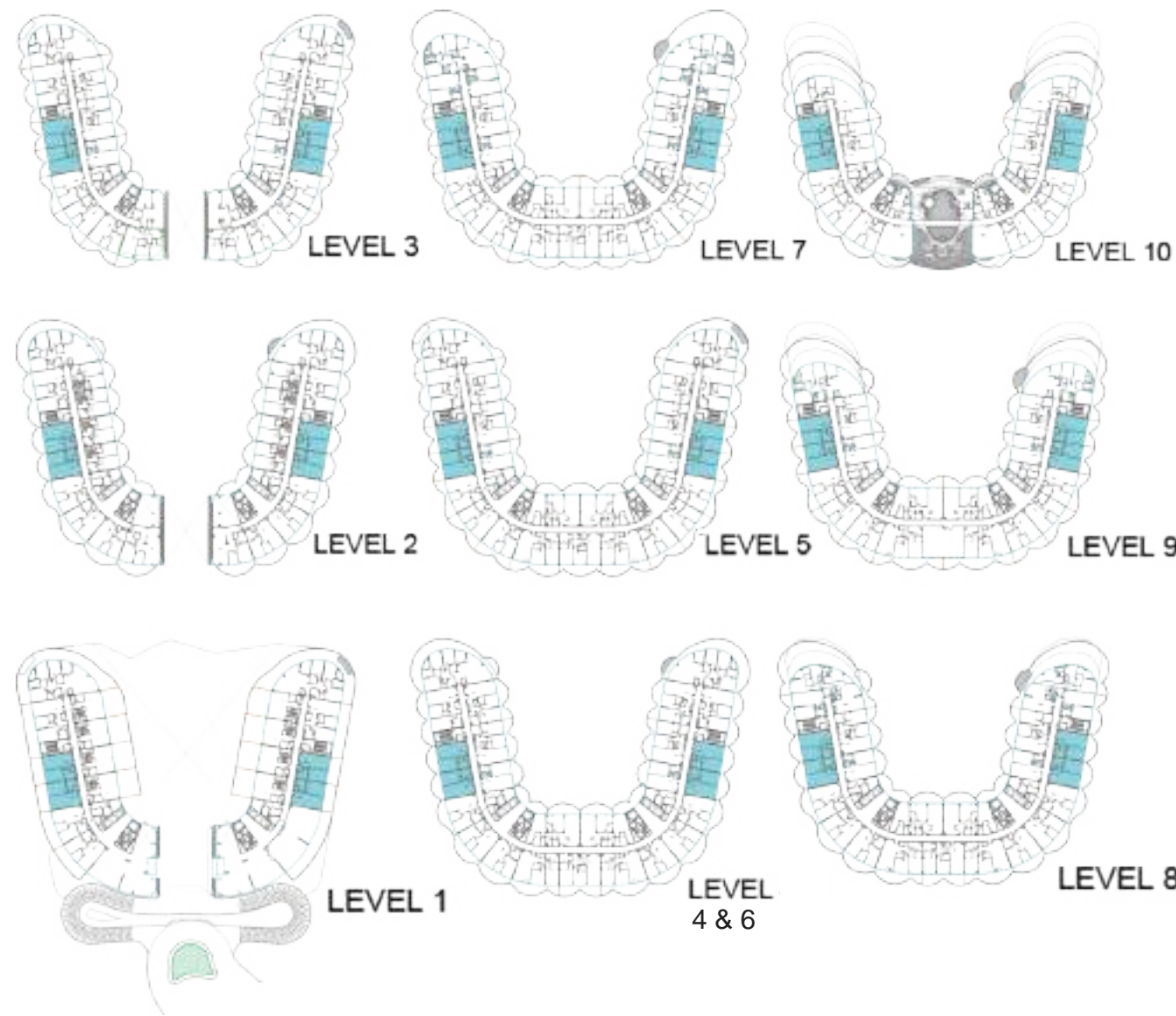

1 BEDROOM

TYPE A

| | | |
|---|----------|--------------|
| 1 | KITCHEN | 3m x 2.9m |
| 2 | LIVING | 6.6m x 4.0m |
| 3 | BALCONY | MIN. 1m wide |
| 4 | BEDROOM | 3.8m x 5.4m |
| 5 | BATH | 2.9m x 2.9m |
| 6 | PWD ROOM | 1.8m x 1.8m |
| 7 | LAUNDRY | 0.9m x 1.6m |

| | From | To |
|--------------|-----------------|-----------------|
| Suite Area | 850.78sq. ft. | 861.22sq. ft. |
| Balcony Area | 241.33 sq. ft. | 310.11 sq. ft. |
| Total Area | 1092.11 sq. ft. | 1171.33 sq. ft. |

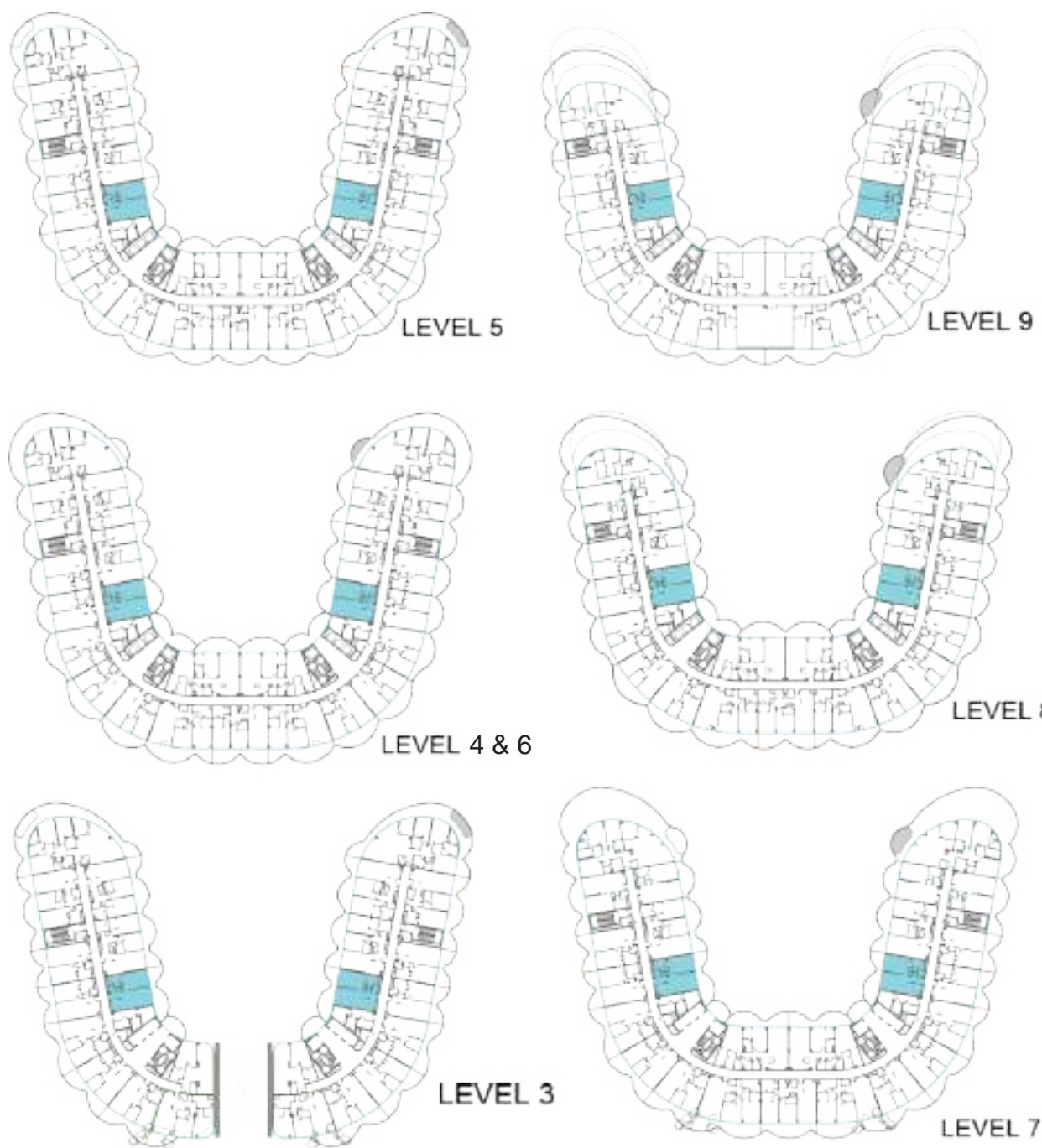

1 BEDROOM

TYPE A 2

| | | |
|---|----------|----------------|
| 1 | KITCHEN | 2.8m x 3.1m |
| 2 | LIVING | 4m x 6.5m |
| 3 | BALCONY | MIN. 1.2m wide |
| 4 | BEDROOM | 3.8m x 5.9m |
| 5 | BATH | 3m x 1.9m |
| 6 | PWD ROOM | 1.8m x 1.8m |
| 7 | LAUNDRY | 0.9m x 0.9m |

| | From | To |
|--------------|----------------|----------------|
| Suite Area | 840.34sq. ft. | 840.55sq. ft. |
| Balcony Area | 224.97sq. ft. | 337.02sq. ft. |
| Total Area | 1065.30sq. ft. | 1177.57sq. ft. |

*All images used for illustrative purposes only and do not represent the actual size, feature specificatons, fitting, and furnishing. The developer reserves the right to make revision / alterations, at its absolute discretion, without any liability whatsoever.



ENTRY

1 BEDROOM

TYPE A 3

| | | |
|---|----------|----------------|
| 1 | KITCHEN | 2.8m x 3.1m |
| 2 | LIVING | 3.8m x 6.5m |
| 3 | BALCONY | MIN 1.0 m wide |
| 4 | BEDROOM | 3.9m x 4.5m |
| 5 | BATH | 2m x 2.8m |
| 6 | PWD ROOM | 1.8m x 1.8m |
| 7 | LAUNDRY | 1m x 1m |



LEVEL 7

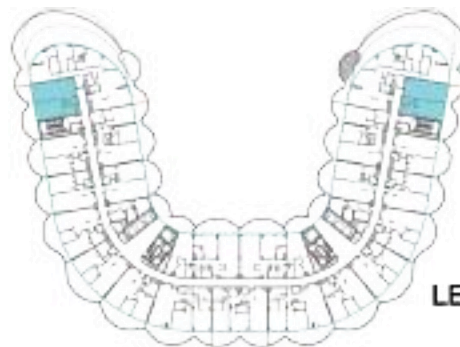

LEVEL 8

| | From | To |
|--------------|----------------|----------------|
| Suite Area | 843.14sq. ft. | 845.7sq. ft. |
| Balcony Area | 357.68sq. ft. | 357.58sq. ft. |
| Total Area | 1200.82sq. ft. | 1202.65sq. ft. |



ENTRY

1 BEDROOM

TYPE A 4

| | | |
|---|----------|----------------|
| 1 | KITCHEN | 2.4m x 2.8m |
| 2 | LIVING | 3.9m x 6.1m |
| 3 | BALCONY | MIN. 1.2m wide |
| 4 | BEDROOM | 3.8m x 5.7m |
| 5 | BATH | 1.9m x 2.6m |
| 6 | PWD ROOM | 1.8m x 1.5m |
| 7 | LAUNDRY | 1m x 1m |

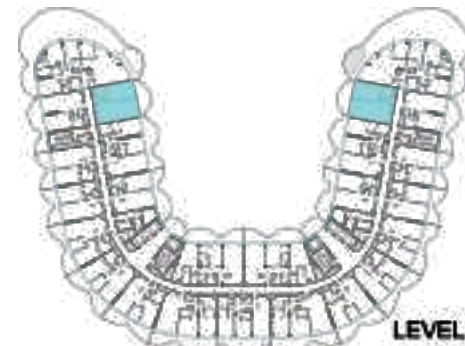

LEVEL 7

| | From | To |
|--------------|----------------|----------------|
| Suite Area | 848.09sq. ft. | 848.20sq. ft. |
| Balcony Area | 236.05sq. ft. | 236.05sq. ft. |
| Total Area | 1084.14sq. ft. | 1084.25sq. ft. |

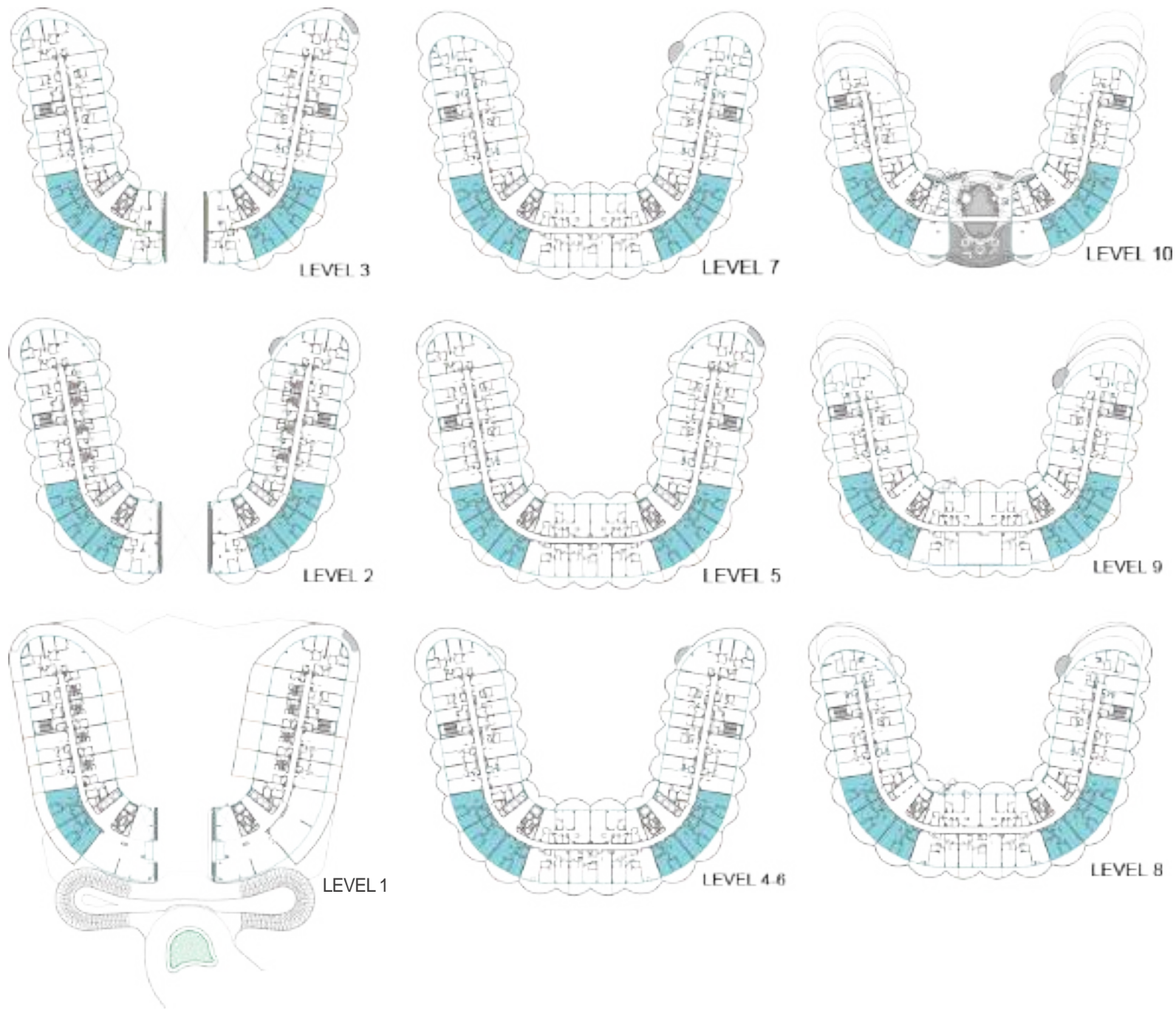

1 BEDROOM

TYPE B

| | | |
|---|----------|----------------|
| 1 | KITCHEN | 3m x 3.3m |
| 2 | LIVING | 4.1m x 6.3m |
| 3 | STUDY | 2.7m x 3.5m |
| 4 | BALCONY | MIN. 1.2m wide |
| 5 | BEDROOM | 3.7m x 5.3m |
| 6 | BATH | 2m x 2.8m |
| 7 | PWD ROOM | 1.3m x 1.8m |
| 8 | LAUNDRY | 0.9m x 1.6m |

| | From | To |
|--------------|----------------|----------------|
| Suite Area | 971.23sq. ft. | 974.46sq. ft. |
| Balcony Area | 297.08sq. ft. | 437.55sq. ft. |
| Total Area | 1268.31sq. ft. | 1412.01sq. ft. |

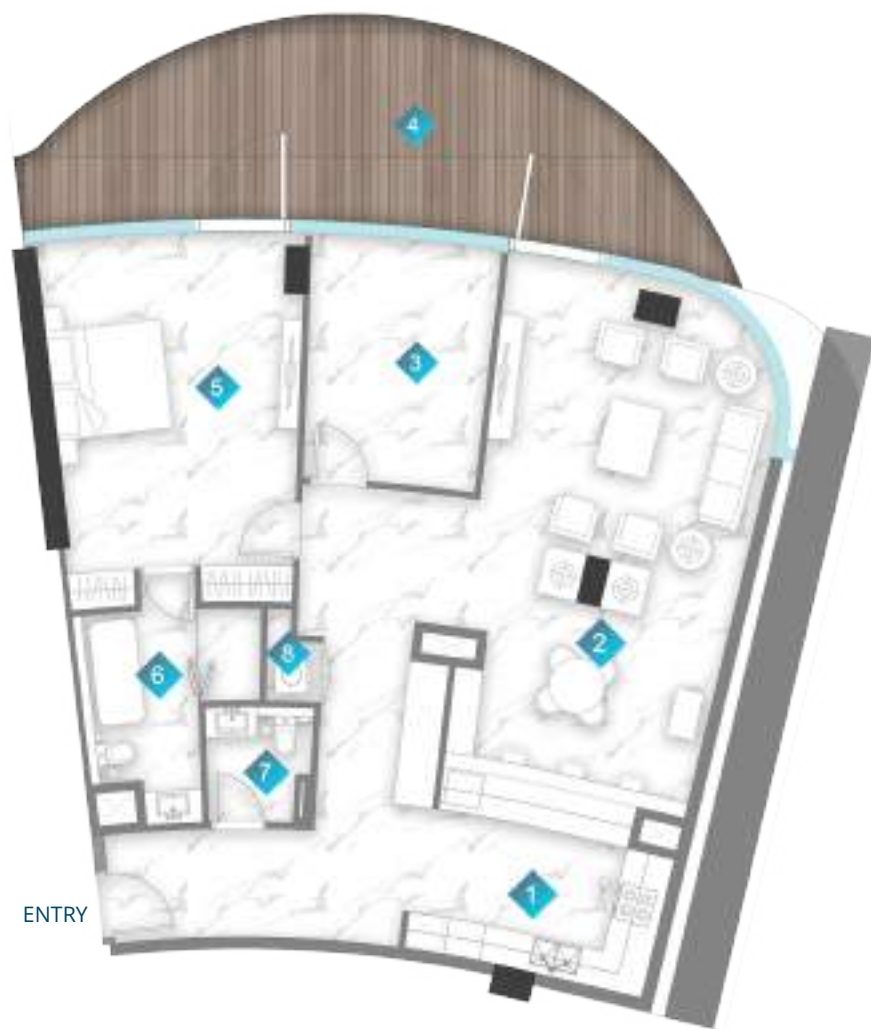

1 BEDROOM

TYPE C

| | | |
|---|----------|-------------|
| 1 | KITCHEN | 3m x 3.9m |
| 2 | LIVING | 4m x 8.6m |
| 3 | STUDY | 3.1m x 4m |
| 4 | BALCONY | Varies |
| 5 | BEDROOM | 4.5m x 5.5m |
| 6 | BATH | 1.8m x 3m |
| 7 | PWD ROOM | 1.8m x 1.8m |
| 8 | LAUNDRY | 0.9m x 0.9m |

| | From | To |
|--------------|----------------|----------------|
| Suite Area | 1390.27sq. ft. | 1390.27sq. ft. |
| Balcony Area | 339.17sq. ft. | 339.17sq. ft. |
| Total Area | 1729.44sq. ft. | 1729.44sq. ft. |

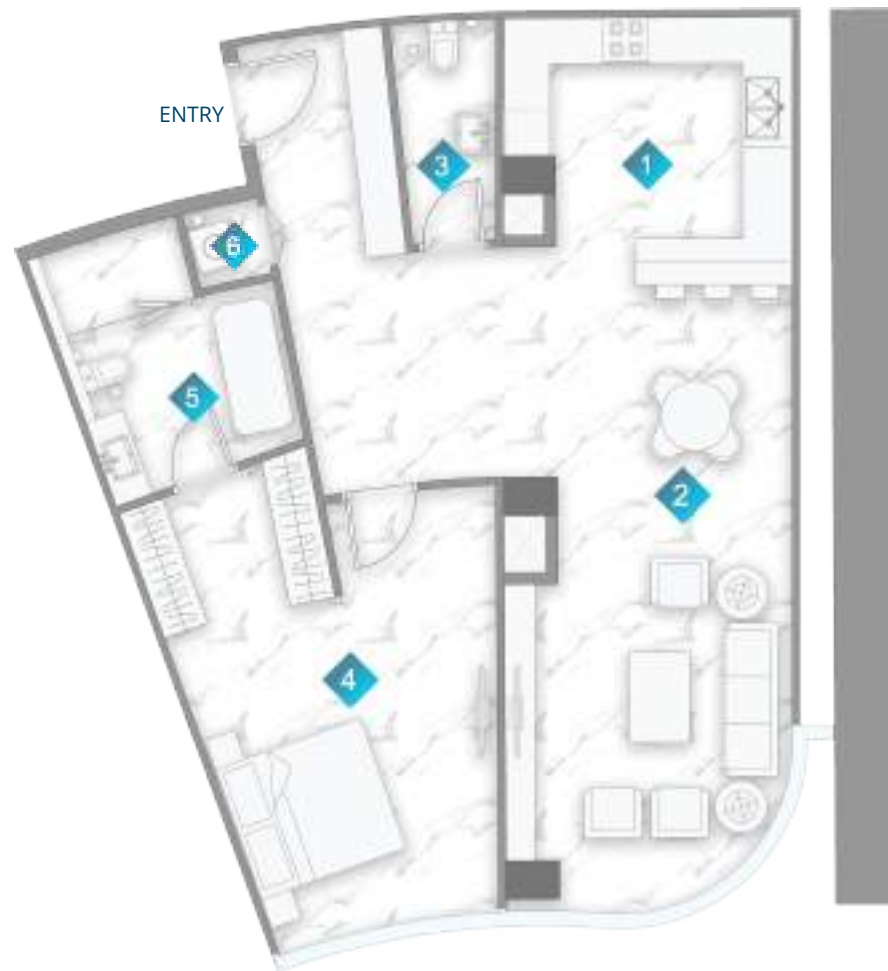

1 BEDROOM

TYPE D

| | | |
|---|----------|-------------|
| 1 | KITCHEN | 3.7m x 3.5m |
| 2 | LIVING | 3.7m x 8.1m |
| 3 | PWD ROOM | 1.4m x 2.8m |
| 4 | BEDROOM | 2.9m x 5.5m |
| 5 | BATH | 2.9m x 3.4m |
| 6 | LAUNDRY | 1m x 1m |

| | From | To |
|--------------|----------------|----------------|
| Suite Area | 1030.97sq. ft. | 1031.18sq. ft. |
| Balcony Area | - | - |
| Total Area | 1030.97sq. ft. | 1031.18sq. ft. |

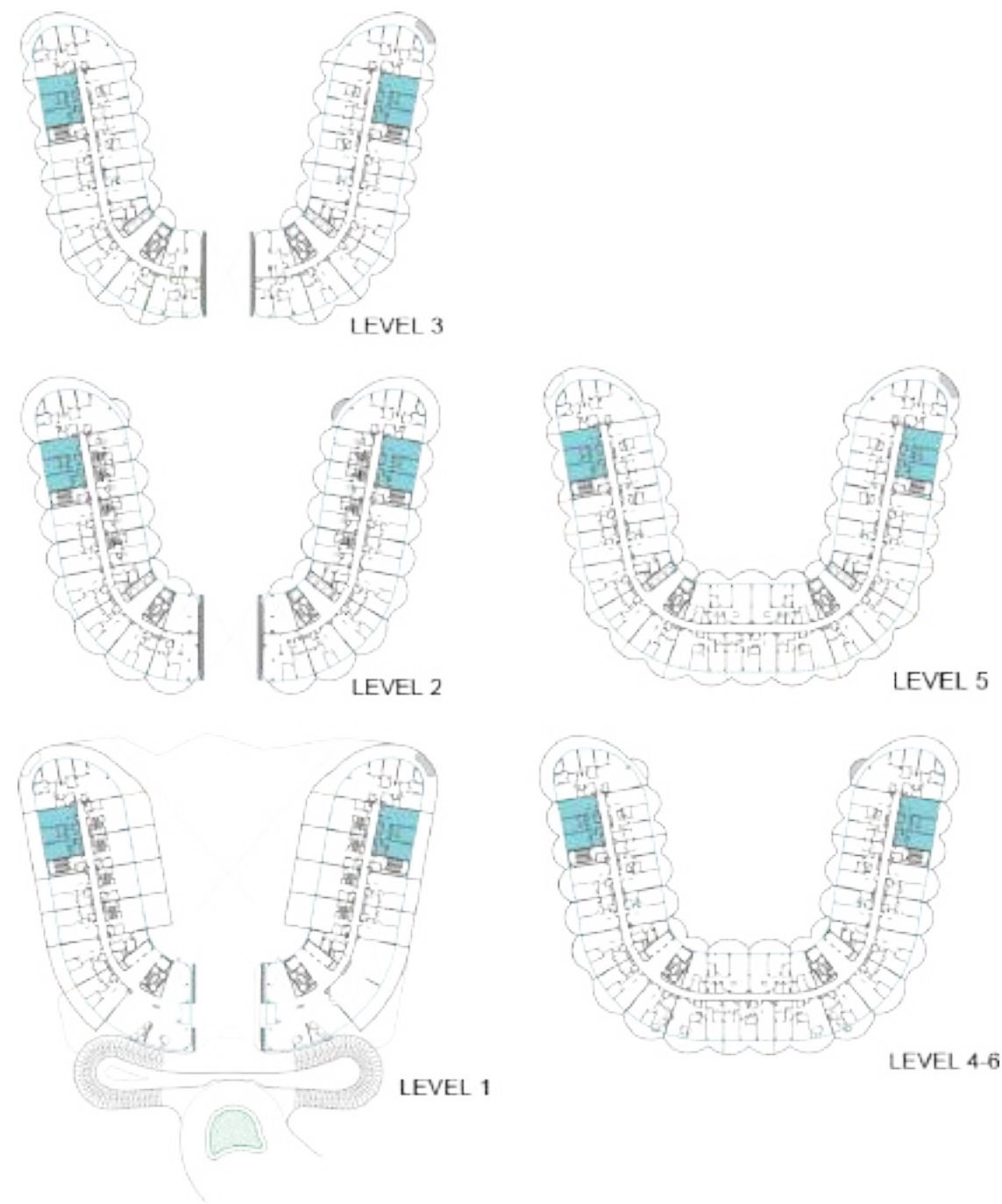

2 BEDROOM

TYPE A

| | | |
|---|----------|----------------|
| 1 | KITCHEN | 2.9m x 3.0m |
| 2 | LIVING | 4.3m x 6.6m |
| 3 | PWD ROOM | 2.1m x 1.6m |
| 4 | LAUNDRY | 1.2m x 1.6m |
| 5 | BEDROOM | 3.5m x 3.5m |
| 6 | BATH | 2.6m x 1.7m |
| 7 | BEDROOM | 3.9m x 4.2m |
| 8 | BATH | 2.6m x 2.6m |
| 9 | BALCONY | MIN. 1.2m wide |

| | From | To |
|--------------|----------------|----------------|
| Suite Area | 1270.57sq. ft. | 1271.33sq. ft. |
| Balcony Area | 478.35 sq. ft. | 619.21sq. ft. |
| Total Area | 1748.92sq. ft. | 1890.57sq. ft. |

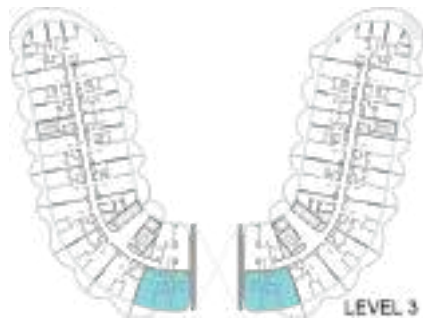

2 BEDROOM

TYPE B

| | | |
|---|----------|-------------|
| 1 | KITCHEN | 2.8m x 3.7m |
| 2 | LIVING | 4.9m x 6.2m |
| 3 | BALCONY | Varies |
| 4 | PWD ROOM | 1.7m x 1.4m |
| 5 | BEDROOM | 4.2m x 3.6m |
| 6 | BATH | 2.6m x 1.8m |
| 7 | BEDROOM | 4.0m x 4.7m |
| 8 | BATH | 3.2m x 2.7m |
| 9 | LAUNDRY | 0.9m x 1.4m |

| | From | To |
|--------------|----------------|----------------|
| Suite Area | 1326.01sq. ft. | 1326.01sq. ft. |
| Balcony Area | 170.39 sq. ft. | 170.61 sq. ft. |
| Total Area | 1496.40sq. ft. | 1496.61sq. ft. |

*All images used for illustrative purposes only and do not represent the actual size, feature specificatons, fitting, and furnishing. The developer reserves the right to make revision / alterations, at its absolute discretion, without any liability whatsoever.

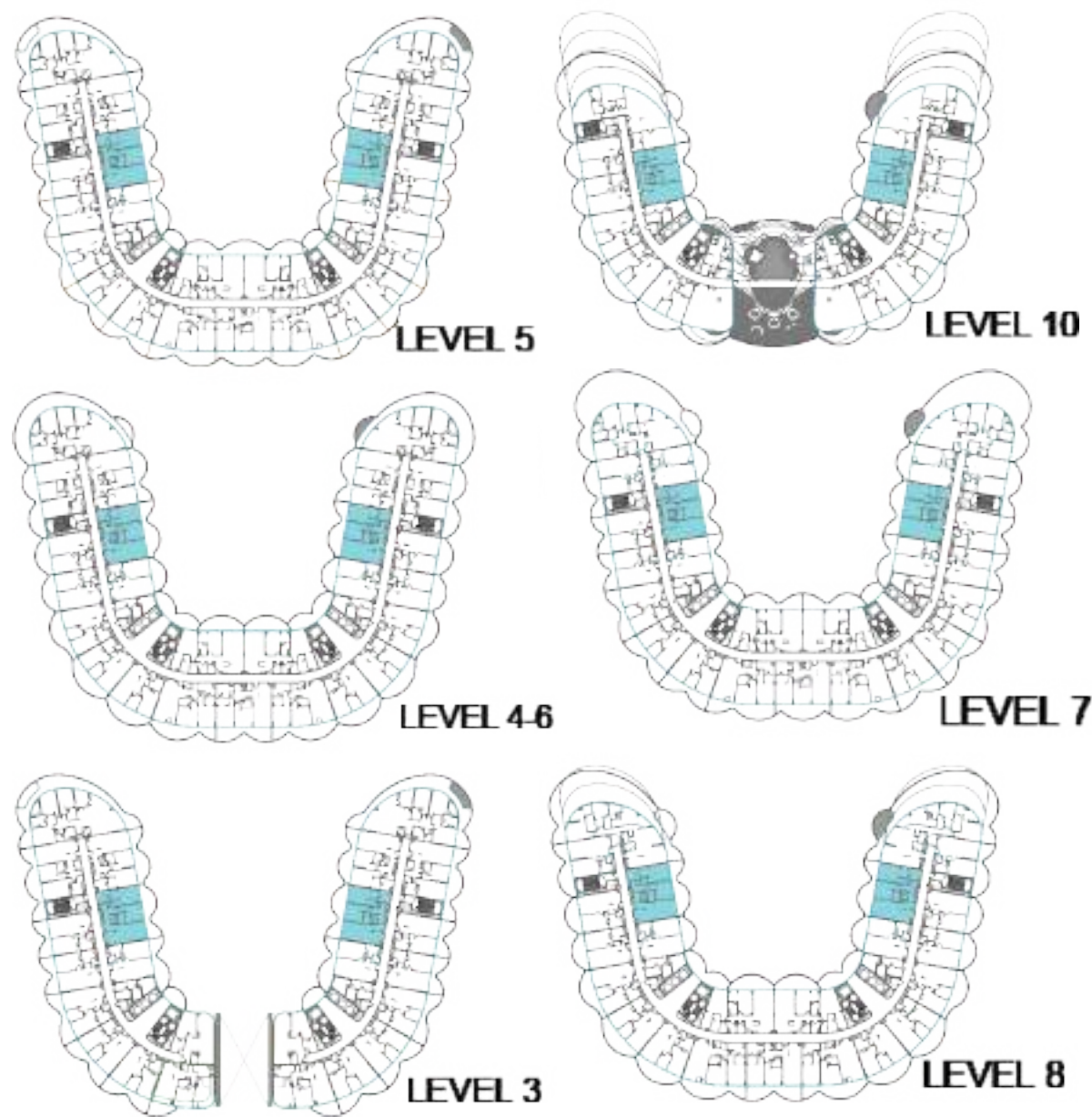

2 BEDROOM

TYPE C

| | | |
|---|----------|---------------|
| 1 | KITCHEN | 2.9m x 3.1m |
| 2 | LIVING | 4.3m x 6.5m |
| 3 | BALCONY | Min 1.2m wide |
| 4 | BEDROOM | 4.2m x 3.5m |
| 5 | BATH | 2.6m x 1.6m |
| 6 | BEDROOM | 3.8m x 4.7m |
| 7 | BATH | 2.5m x 2.9m |
| 8 | PWD ROOM | 1.9m x 0.9m |
| 9 | LAUNDRY | 1.2m x 1.1m |

| | From | To |
|--------------|-----------------|----------------|
| Suite Area | 1267.34 sq. ft. | 1281.34sq. ft. |
| Balcony Area | 343.48 sq. ft. | 350.47sq. ft. |
| Total Area | 1610.82sq. ft. | 1631.81sq. ft. |



2 BEDROOM

TYPE C 1

| | | |
|---|----------|----------------|
| 1 | KITCHEN | 2.9m x 3.1m |
| 2 | LIVING | 4.3m x 6.2m |
| 3 | PWD ROOM | 1.9m x 1m |
| 4 | BEDROOM | 3.6m x 3.9m |
| 5 | BATH | 2.6m x 1.7m |
| 6 | BEDROOM | 3.8m x 4.7m |
| 7 | BATH | 2.5m x 2.9m |
| 8 | LAUNDRY | 1.9m x 0.9m |
| 9 | BALCONY | MIN. 1.6m wide |

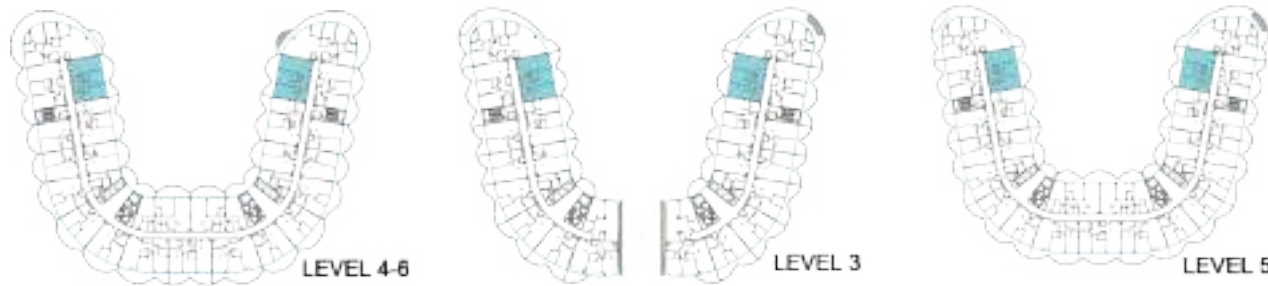

| | From | To |
|--------------|-----------------|-----------------|
| Suite Area | 1280.80 sq. ft. | 1281.23 sq. ft. |
| Balcony Area | 347.78 sq. ft. | 352.20 sq. ft. |
| Total Area | 1628.58 sq. ft. | 1633.42 sq. ft. |



2 BEDROOM

TYPE C 2

| | | |
|---|----------|----------------|
| 1 | KITCHEN | 2.8m x 3m |
| 2 | LIVING | 4.1m x 6.5m |
| 3 | PWD ROOM | 1.8m x 1.6m |
| 4 | BEDROOM | 3.9m x 4.1m |
| 5 | BATH | 2.6m x 1.6m |
| 6 | LAUNDRY | 1.2m x 1.1m |
| 7 | BEDROOM | 3.8m x 4.7m |
| 8 | BATH | 2.5m x 2.9m |
| 9 | BALCONY | MIN. 1.2m wide |

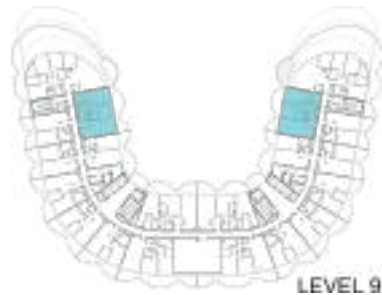

| | From | To |
|--------------|----------------|-----------------|
| Suite Area | 1277.78sq. ft. | 1277.89 sq. ft. |
| Balcony Area | 353.27sq. ft. | 353.38 sq. ft. |
| Total Area | 1631.06sq. ft. | 1631.27sq. ft. |

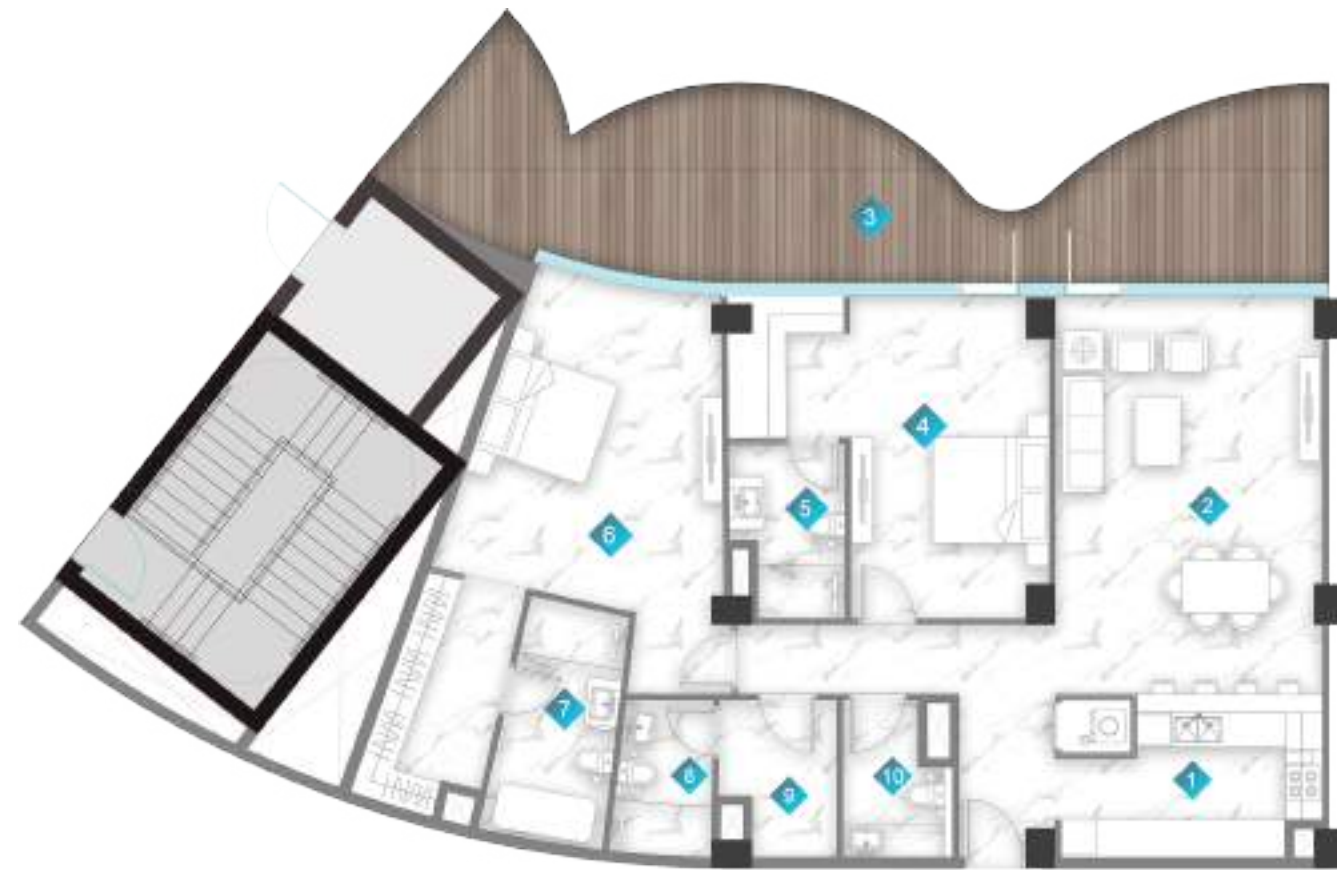

ENTRY



2 BEDROOM TYPE D

| | | |
|----|----------|----------------|
| 1 | KITCHEN | 3.2m x 2.8m |
| 2 | LIVING | 4.6m x 6.8m |
| 3 | BALCONY | MIN. 1.3m wide |
| 4 | BEDROOM | 3.4m x 5.5m |
| 5 | BATH | 2.0m x 2.9m |
| 6 | BEDROOM | 3.1m x 5.5m |
| 7 | BATH | 1.7m x 4m |
| 8 | BATH | 2.7m x 1.7m |
| 9 | STORE | 2m x 2.7m |
| 10 | PWD ROOM | 1.8m x 2.7m |

| | From | To |
|--------------|-----------------|-----------------|
| Suite Area | 1572.18 sq. ft. | 1576.27 sq. ft. |
| Balcony Area | 296.33 sq. ft. | 396.11 sq. ft. |
| Total Area | 1868.51sq. ft. | 1972.38 sq. ft. |



ENTRY



2 BEDROOM TYPE E

| | | |
|----|----------|----------------|
| 1 | KITCHEN | 4.4m x 2.6m |
| 2 | LIVING | 4.1m x 4.2m |
| 3 | DINING | 4.2m x 4.2m |
| 4 | BALCONY | MIN. 3.2m wide |
| 5 | BEDROOM | 3.7m x 3.9m |
| 6 | BATH | 1.6m x 3.4m |
| 7 | PWD ROOM | 1.9m x 1.6m |
| 8 | LAUNDRY | 2.1m x 1m |
| 9 | BEDROOM | 3.6m x 4m |
| 10 | BATH | 3.1m x 2.6m |
| 11 | STORE | 1.6m x 2.6m |
| 12 | BATH | 1.5m x 1.6m |

| | From | To |
|--------------|-----------------|-----------------|
| Suite Area | 1301.89 sq. ft. | 1303.08 sq. ft. |
| Balcony Area | 586.96 sq. ft. | 586.85 sq. ft. |
| Total Area | 1888.85 sq. ft. | 1889.93 sq. ft. |

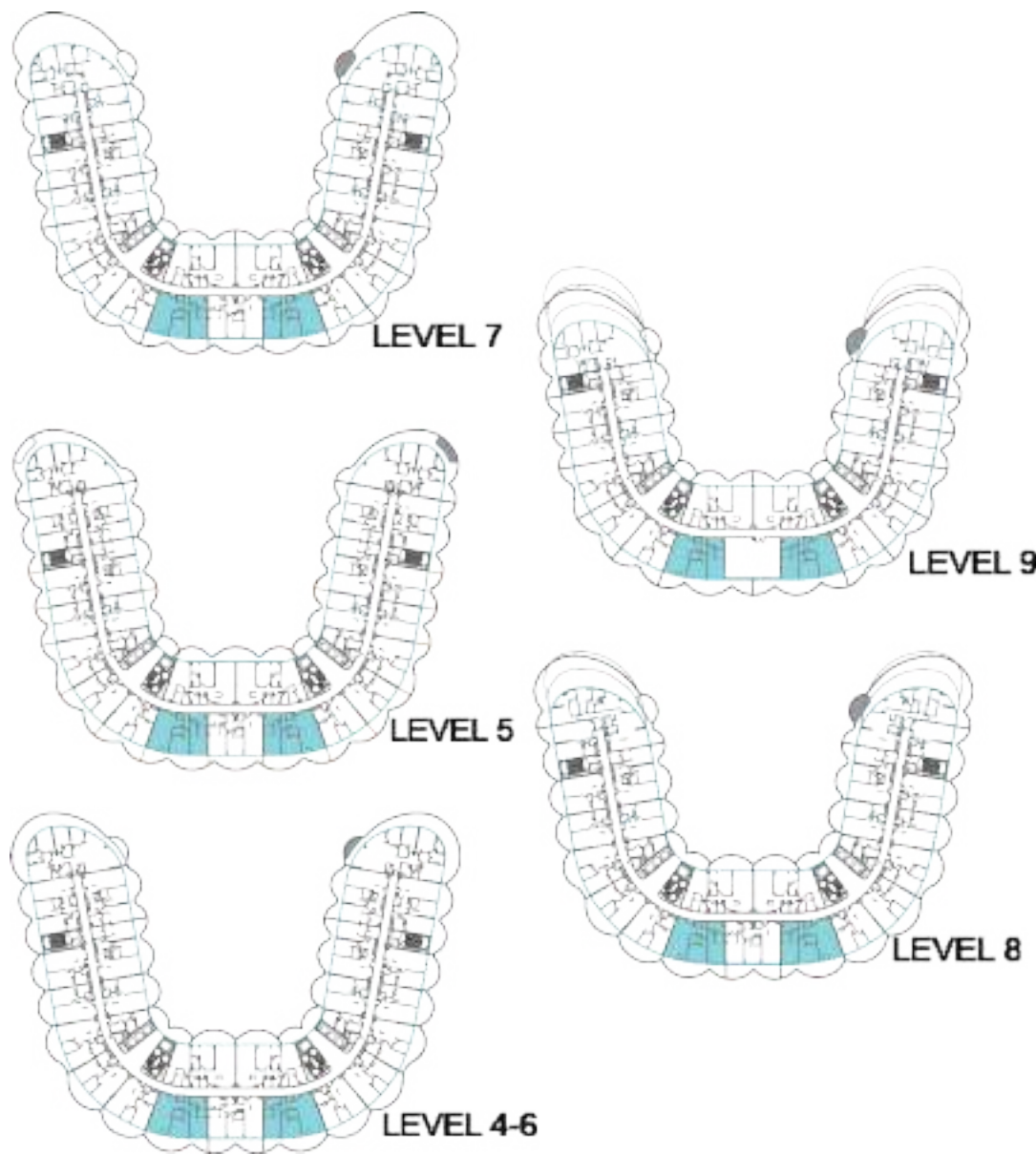

2 BEDROOM

TYPE F

| | | |
|---|----------|-------------|
| 1 | KITCHEN | 3m x 3.2m |
| 2 | LIVING | 5.3m x 6.6m |
| 3 | BALCONY | Varies |
| 4 | BEDROOM | 4.8m x 3.6m |
| 5 | BATH | 2.6m x 1.9m |
| 6 | BEDROOM | 4.1m x 4.7m |
| 7 | BATH | 2.5m x 2.7m |
| 8 | LAUNDRY | 1.1m x 1.4m |
| 9 | PWD ROOM | 1.7m x 1.4m |

| | From | To |
|--------------|----------------|----------------|
| Suite Area | 1360.99sq. ft. | 1350.22sq. ft. |
| Balcony Area | 432.92sq. ft. | 625.49sq. ft. |
| Total Area | 1793.91sq. ft. | 1975.72sq. ft. |

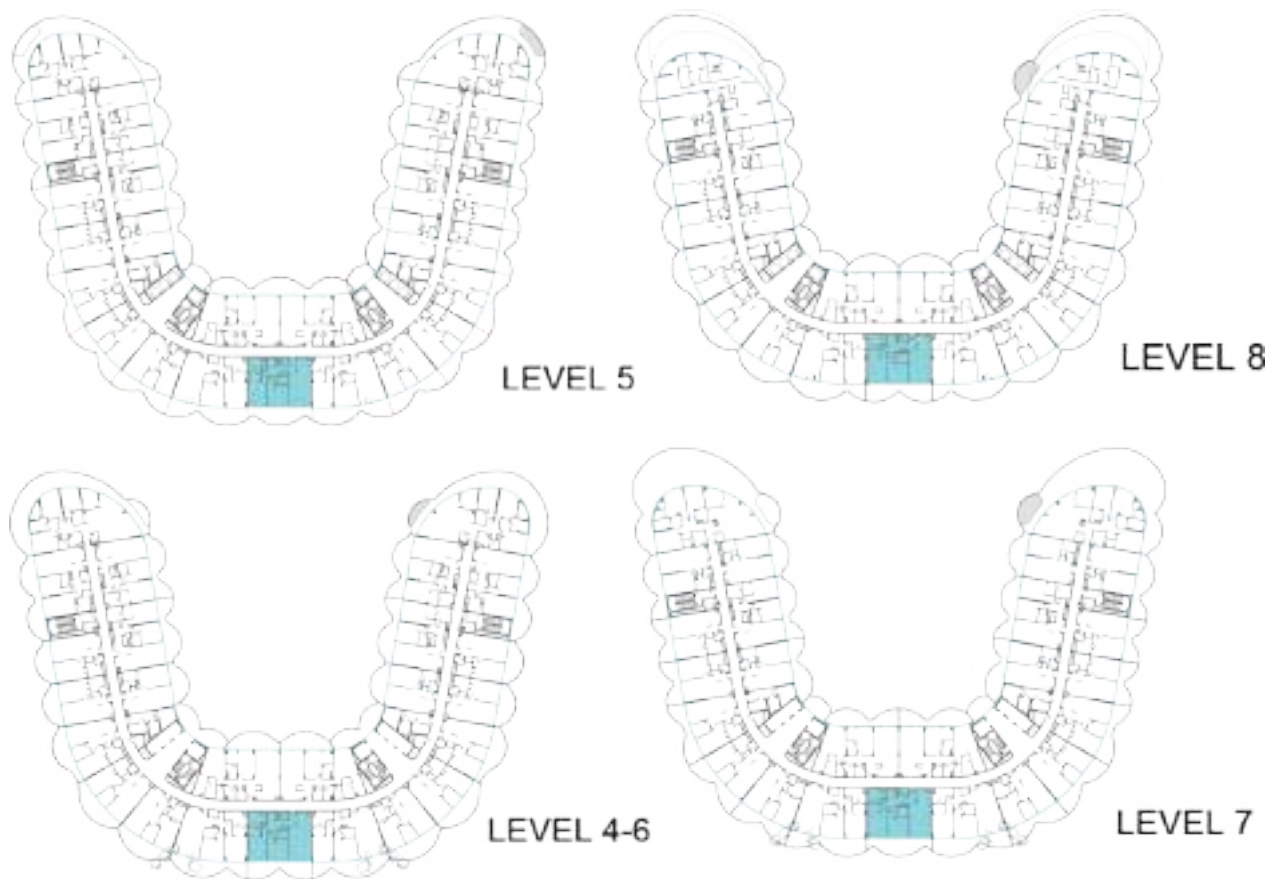

2 BEDROOM

TYPE G

| | | |
|---|----------|----------------|
| 1 | KITCHEN | 3m x 3.1m |
| 2 | LIVING | 4.3m x 6.5m |
| 3 | BALCONY | MIN. 1.3m wide |
| 4 | BEDROOM | 4.2m x 4.1m |
| 5 | BATH | 2.6m x 1.7m |
| 6 | PWD ROOM | 2.1m x 1.7m |
| 7 | LAUNDRY | 1.8m x 1.7m |
| 8 | BEDROOM | 3.8m x 4.7m |
| 9 | BATH | 2.5m x 2.9m |

| | From | To |
|--------------|----------------|----------------|
| Suite Area | 1296.30sq. ft. | 1296.41sq. ft. |
| Balcony Area | 350.80sq. ft. | 390.08sq. ft. |
| Total Area | 1647.09sq. ft. | 1686.49sq. ft. |

*All images used for illustrative purposes only and do not represent the actual size, feature specificatons, fitting, and furnishing. The developer reserves the right to make revision / alterations, at its absolute discretion, without any liability whatsoever.

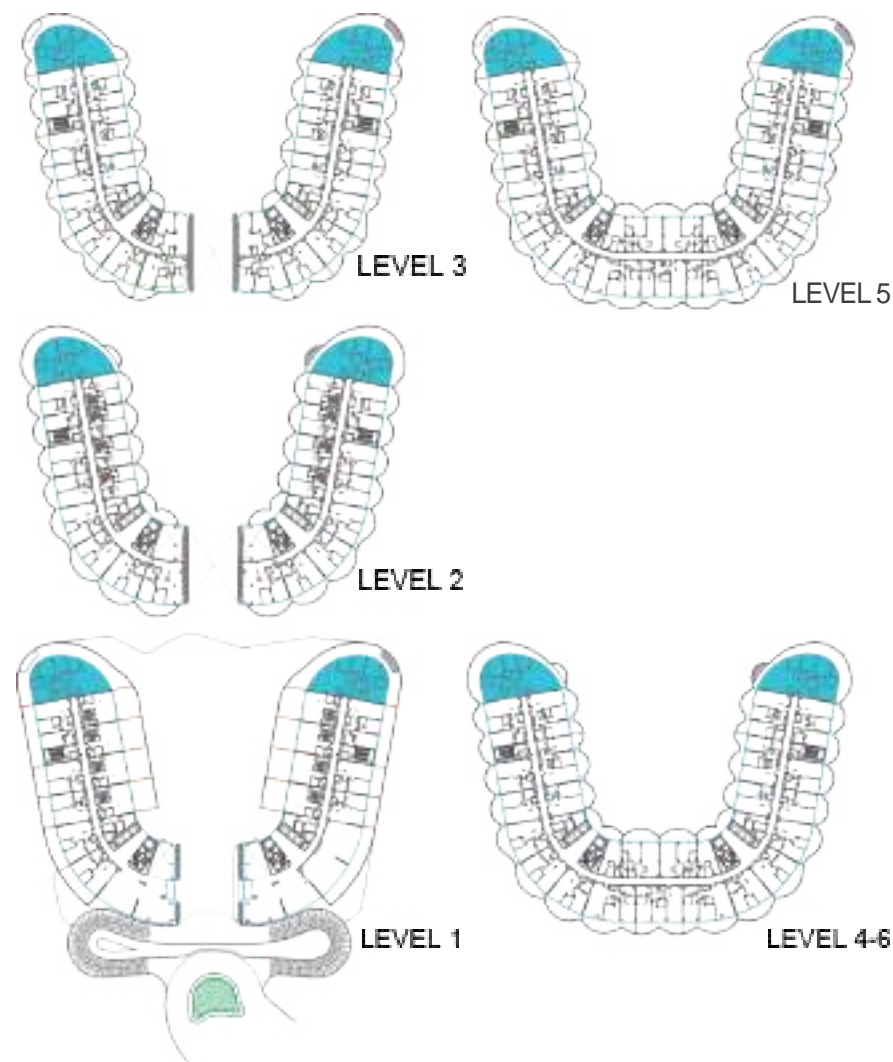

| | From | To |
|--------------|-----------------|-----------------|
| Suite Area | 2135.02 sq. ft. | 2135.56 sq. ft. |
| Balcony Area | 1140.87 sq. ft. | 1644.19 sq. ft. |
| Total Area | 3275.89sq. ft. | 3779.75 sq. ft. |

3 BEDROOM

TYPE A

| | | |
|----|--------------|---------------|
| 1 | KITCHEN | 3.6m x 2.5m |
| 2 | LIVING | 8m x 9.5m |
| 3 | BALCONY | MIN.1.2m wide |
| 4 | STUDY | 3.5m x 4.2m |
| 5 | BEDROOM | 3.4m x 4.2m |
| 6 | BATH | 2.2m x 2.7m |
| 7 | PWD ROOM | 1.6m x 2.1m |
| 8 | M. BEDROOM | 3.7m x 3.7m |
| 9 | BATH | 2.6m x 3.0m |
| 10 | BATH | 2.5m x 3.4m |
| 11 | BEDROOM | 5.0m x 3.9m |
| 12 | STORE | 2.4m x 2.8m |
| 13 | LAUNDRY | 1.1m x 0.9m |
| 14 | BATH | 1.9m x 1.6m |
| 15 | PRIVATE POOL | |

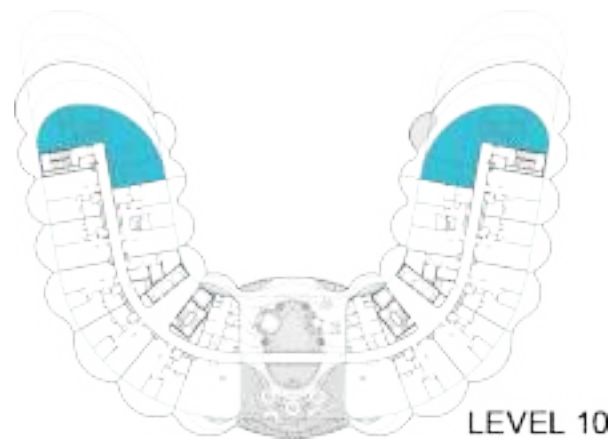
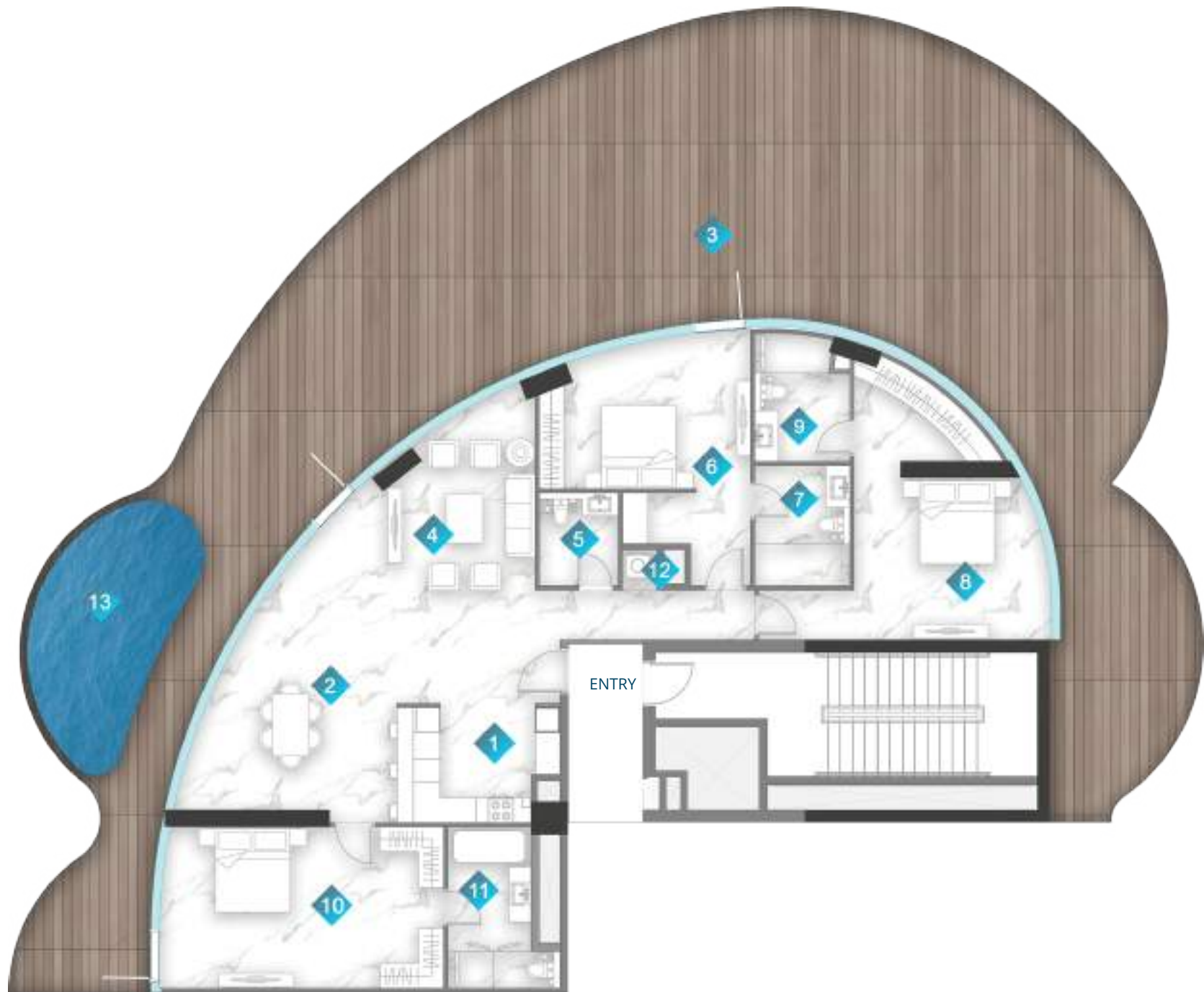

| | From | To |
|--------------|----------------|----------------|
| Suite Area | 2031.15sq. ft. | 2030.29sq. ft. |
| Balcony Area | 2467.63sq. ft. | 2468.70sq. ft. |
| Total Area | 4498.78sq. ft. | 4498.99sq. ft. |

3 BEDROOM

TYPE B

| | | |
|----|--------------|----------------|
| 1 | KITCHEN | 3.2m x 2.8m |
| 2 | DINING | 5.4m x 2.8m |
| 3 | BALCONY | MIN. 1.5m wide |
| 4 | LIVING | 7.7m x 3.5m |
| 5 | PWD ROOM | 1.9m x 2.2m |
| 6 | BEDROOM | 4.4m x 3.0m |
| 7 | BATH | 2.2m x 2.9m |
| 8 | BEDROOM | 4.8m x 6.8m |
| 9 | BATH | 2.2m x 2.8m |
| 10 | BEDROOM | 6.5m x 3.9m |
| 11 | BATH | 2.7m x 3.9m |
| 12 | LAUNDRY | 1m x 1m |
| 13 | PRIVATE POOL | |

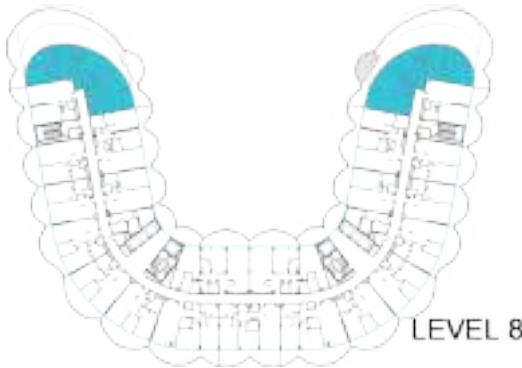

| | From | To |
|--------------|----------------|----------------|
| Suite Area | 2081.09sq. ft. | 2082.31sq. ft. |
| Balcony Area | 2353.53sq. ft. | 2353.31sq. ft. |
| Total Area | 4434.62sq. ft. | 4434.62sq. ft. |

3 BEDROOM

TYPE C

| | | |
|----|--------------|------------------|
| 1 | KITCHEN | 4.2m x 2.4m |
| 2 | DINING | 4.7m x 3.9m |
| 3 | LIVING | 6m x 4m |
| 4 | LAUNDRY | 1.2m x 1m |
| 5 | PWD ROOM | 2.3m x 1.5m |
| 6 | BEDROOM | 6.7m x 4.4m |
| 7 | BATH | 1.2m x 2.5m |
| 8 | BATH | 3.6m x 2.9m |
| 9 | BEDROOM | 3.5m x 3.1m |
| 10 | BATH | 1.6m x 2.9m |
| 11 | BEDROOM | 4.7m x 7.2m |
| 12 | BATH | 2m x 3.9m |
| 13 | STORE | 1.7m x 2.5m |
| 14 | BALCONY | MIN. 1.54 m wide |
| 15 | PRIVATE POOL | |



| | From | To |
|--------------|----------------|----------------|
| Suite Area | 1431.71sq. ft. | 1433.43sq. ft. |
| Balcony Area | 766.28sq. ft. | 765.64sq. ft. |
| Total Area | 2197.99sq. ft. | 2199.07sq. ft. |

3 BEDROOM

TYPE D

| | | |
|----|----------|----------------|
| 1 | KITCHEN | 3m x 3m |
| 2 | LIVING | 6.3m x 4.4m |
| 3 | PWD ROOM | 1.7m x 1.6m |
| 4 | BEDROOM | 3.5m x 3.9m |
| 5 | BATH | 2.2m x 3m |
| 6 | BEDROOM | 3.9m x 3.6m |
| 7 | BATH | 1.8m x 1.8m |
| 8 | BEDROOM | 3.6m x 4.1m |
| 9 | BATH | 1.6m x 2.3m |
| 10 | BALCONY | MIN. 3.2m wide |



| | From | To |
|--------------|----------------|----------------|
| Suite Area | 1781.21sq. ft. | 1781.64sq. ft. |
| Balcony Area | 1587.68sq. ft. | 1587.78sq. ft. |
| Total Area | 3368.89sq. ft. | 3369.43sq. ft. |

3 BEDROOM

TYPE E

| | | |
|----|----------|--------------|
| 1 | KITCHEN | 3.1m x 3.9m |
| 2 | LIVING | 6.2m x 6.5m |
| 3 | PWD ROOM | 1.5m x 1.4m |
| 4 | LAUNDRY | 1m x 1.4m |
| 5 | STUDY | 4.1m x 2.3m |
| 6 | BEDROOM | 3.5m x 3.7m |
| 7 | BATH | 1.9m x 2.2m |
| 8 | BEDROOM | 4.6m x 3.7m |
| 9 | BATH | 2.7m x 1.8m |
| 10 | BALCONY | MIN. 3m wide |
| 11 | BEDROOM | 4.2m x 3.2m |
| 12 | BATH | 3.2m x 3.7m |
| 13 | POOL | |

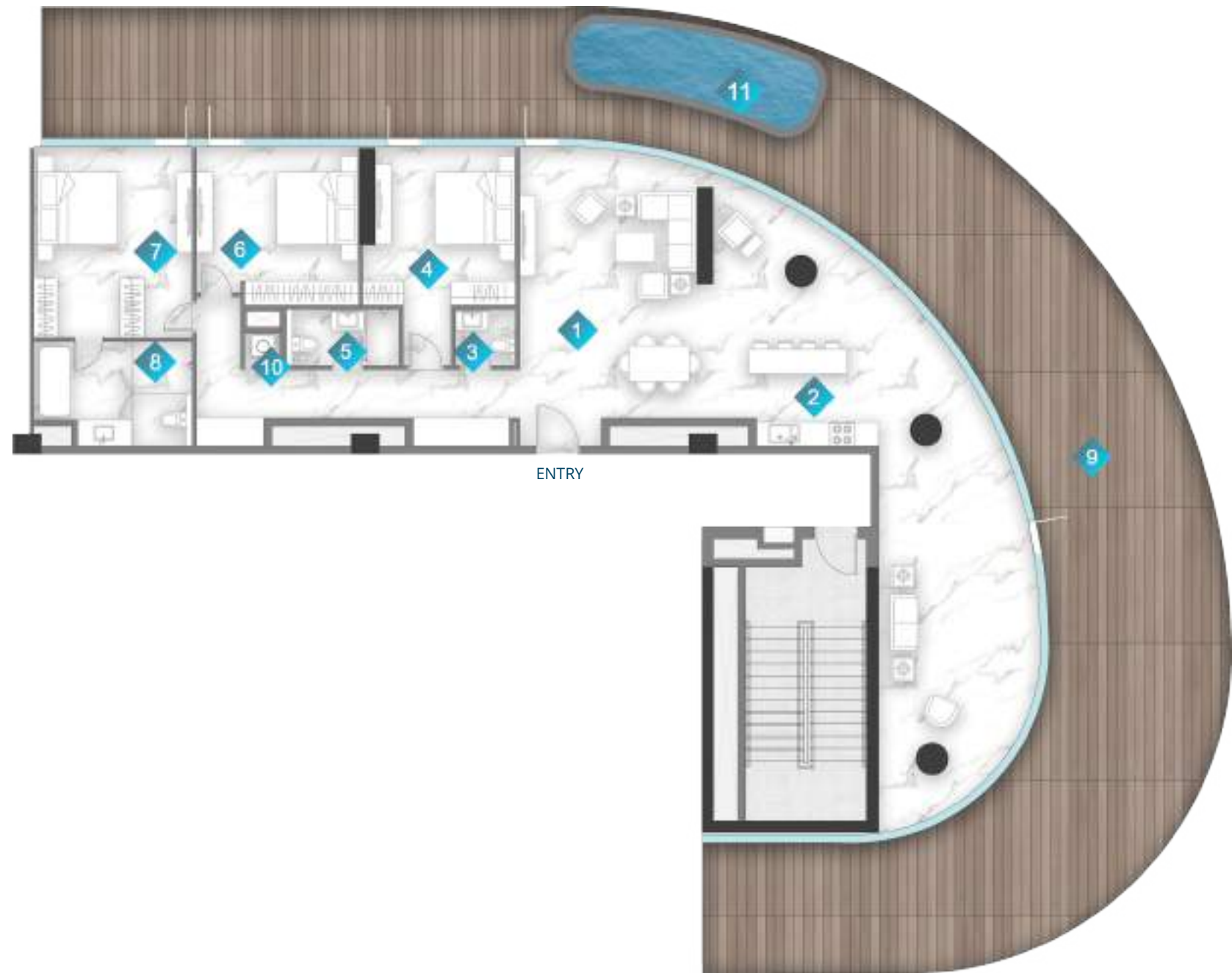

| | From | To |
|--------------|----------------|----------------|
| Suite Area | 2018.45sq. ft. | 2021.35sq. ft. |
| Balcony Area | 1997.57sq. ft. | 1995.31sq. ft. |
| Total Area | 4016.01sq. ft. | 4016.66sq. ft. |

3 BEDROOM

TYPE F

| | | |
|----|--------------|----------------|
| 1 | LIVING | 8.9m x 7.4m |
| 2 | KITCHEN | 3m x 2.6m |
| 3 | PWD ROOM | 1.5m x 1.3m |
| 4 | BEDROOM | 3.3m x 3.4m |
| 5 | BATH | 2.9m x 1.4m |
| 6 | BEDROOM | 4.0m x 3.4m |
| 7 | BEDROOM | 3.3m x 3.9m |
| 8 | BATH | 3.9m x 2.6m |
| 9 | BALCONY | MIN. 1.2m wide |
| 10 | LAUNDRY | 0.9m x 0.9m |
| 11 | PRIVATE POOL | |

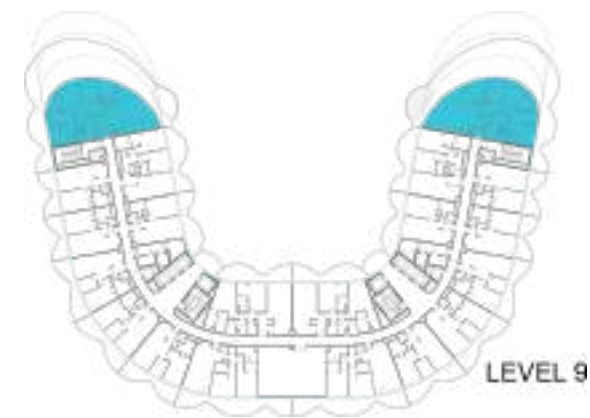
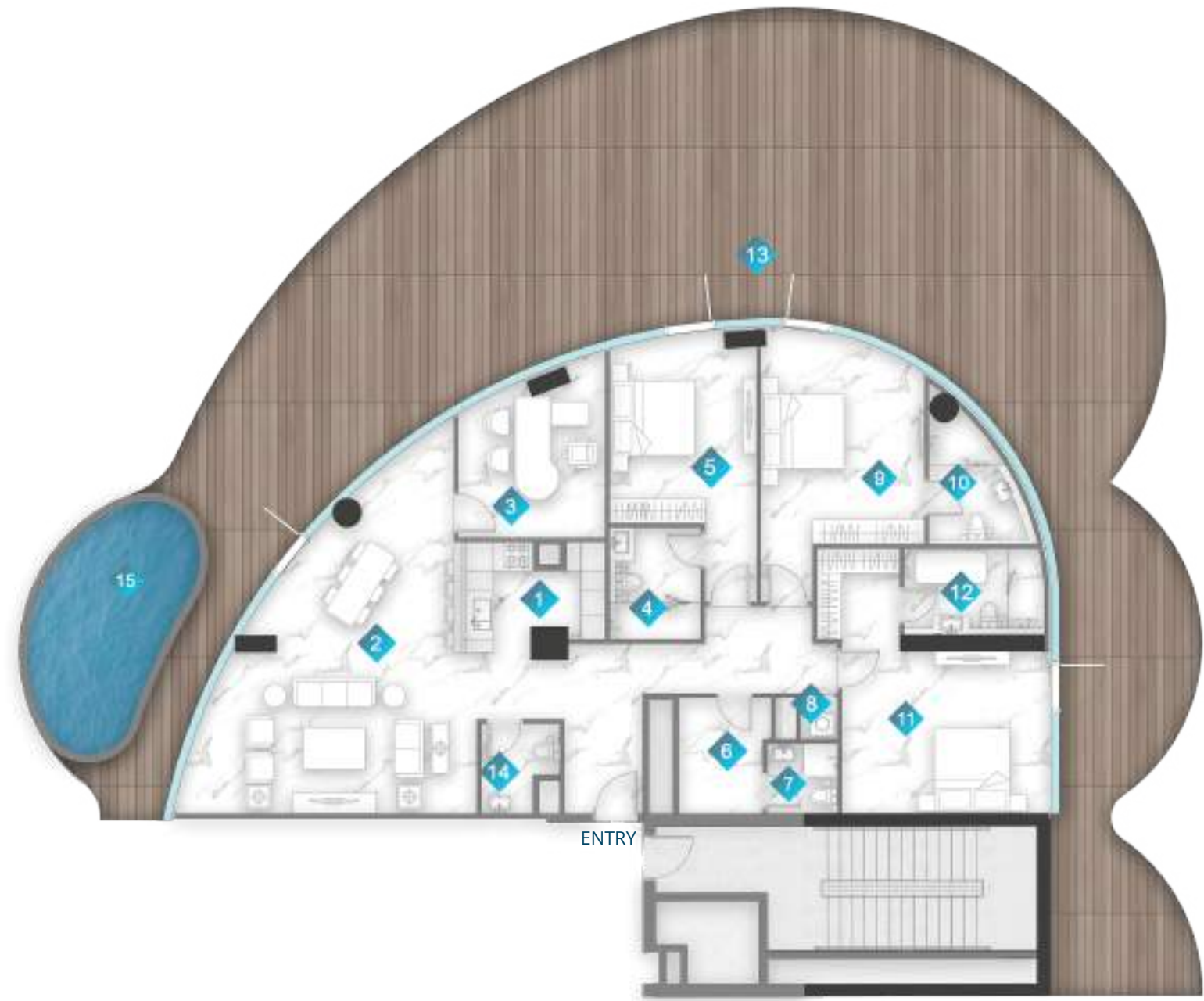

| | From | To |
|--------------|----------------|----------------|
| Suite Area | 2120.28sq. ft. | 2119.31sq. ft. |
| Balcony Area | 2469.13sq. ft. | 2470.32sq. ft. |
| Total Area | 4589.41sq. ft. | 4589.63sq. ft. |

3 BEDROOM

TYPE G

| | | |
|----|--------------|----------------|
| 1 | KITCHEN | 3.5m x 2.5m |
| 2 | LIVING | 7.2m x 9.3m |
| 3 | STUDY | 3.5m x 4.5m |
| 4 | BATH | 2.2m x 2.6m |
| 5 | BEDROOM | 3.5m x 3.6m |
| 6 | STORE | 2.7m x 2.8m |
| 7 | BATH | 1.7m x 1.7m |
| 8 | LAUNDRY | 1.0m x 0.8m |
| 9 | BEDROOM | 3.9m x 3.6m |
| 10 | BATH | 3.9m x 2.6m |
| 11 | BEDROOM | 4.4m x 3.9m |
| 12 | BATH | 3.2m x 2.0m |
| 13 | BALCONY | MIN. 1.5m wide |
| 14 | PWD ROOM | 1.9m x 2.1m |
| 15 | PRIVATE POOL | |

*All images used for illustrative purposes only and do not represent the actual size, feature specificatons, fitting, and furnishing. The developer reserves the right to make revision / alterations, at its absolute discretion, without any liability whatsoever.

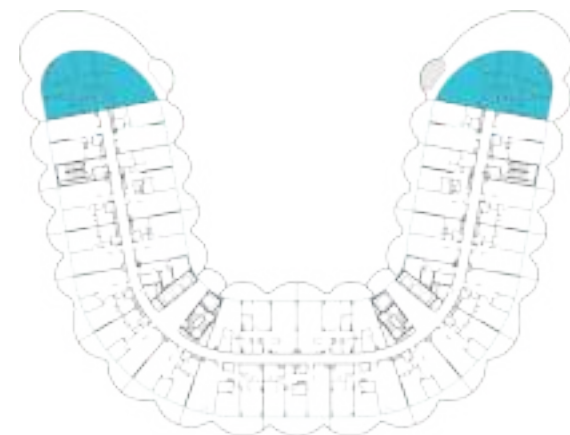

LEVEL 7

| | From | To |
|--------------|----------------|----------------|
| Suite Area | 2145.03sq. ft. | 2145.14sq. ft. |
| Balcony Area | 2351.27sq. ft. | 2351.70sq. ft. |
| Total Area | 4496.30sq. ft. | 4494.84sq. ft. |

3 BEDROOM

TYPE H

| | | |
|----|--------------|----------------|
| 1 | KITCHEN | 3.5m x 2.7m |
| 2 | LIVING | 8.1m x 9.5m |
| 3 | PWD ROOM | 1.6m x 1.7m |
| 4 | STUDY | 3.5m x 4.5m |
| 5 | BEDROOM | 3.5m x 3.6m |
| 6 | BATH | 2.2m x 2.6m |
| 7 | STORE | 2.4m x 2.8m |
| 8 | LAUNDRY | 2.1m x 1m |
| 9 | BATH | 1.7m x 1.7m |
| 10 | BEDROOM | 3.9m x 4.4m |
| 11 | BATH | 3.3m x 1.9m |
| 12 | BEDROOM | 4m x 3.5m |
| 13 | BATH | 2.6m x 4.1m |
| 14 | BALCONY | MIN. 1.2m wide |
| 15 | PRIVATE POOL | |

*All images used for illustrative purposes only and do not represent the actual size, feature specificatons, fitting, and furnishing. The developer reserves the right to make revision / alterations, at its absolute discretion, without any liability whatsoever.

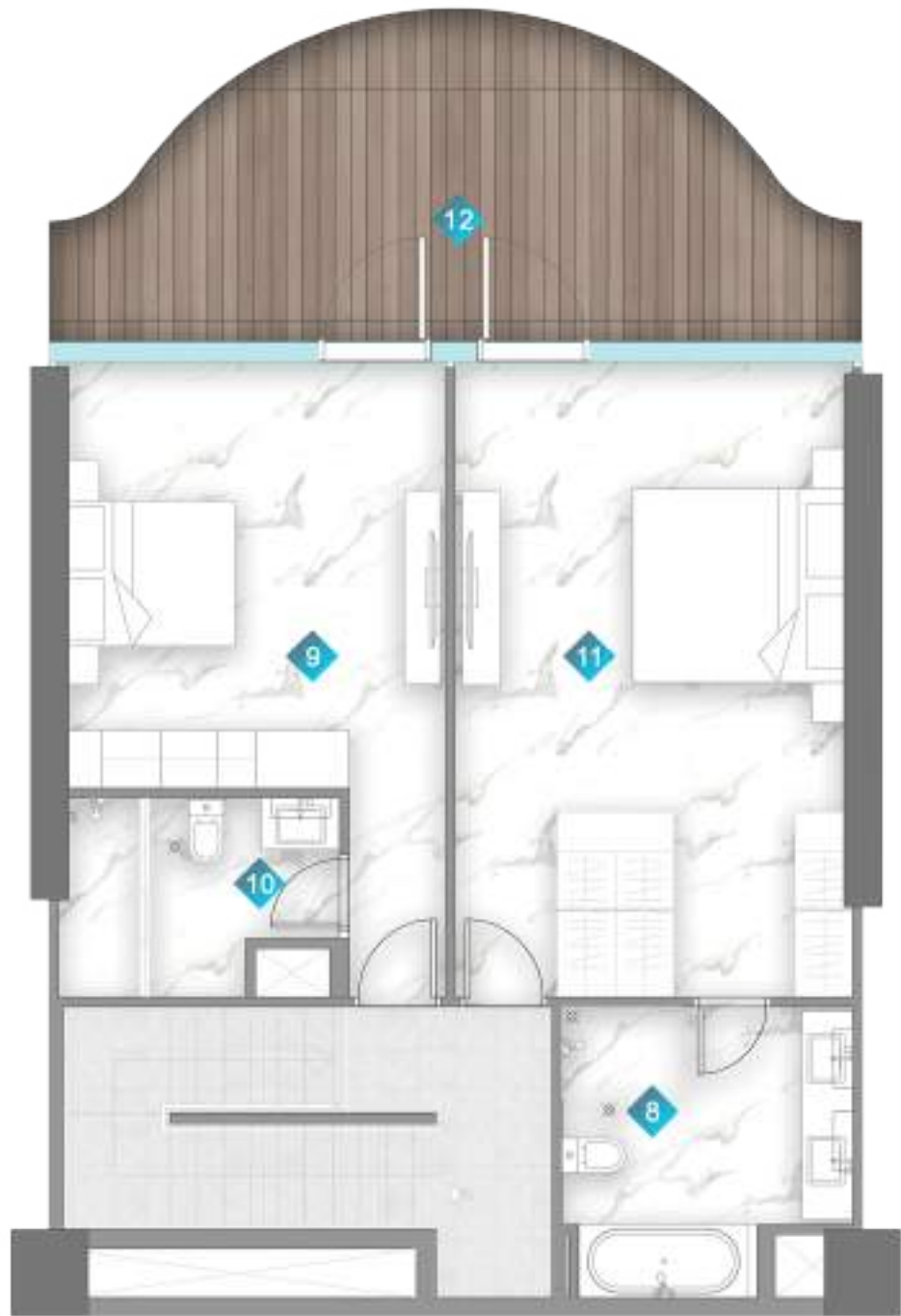

UPPER LEVEL



LOWER LEVEL

ENTRY

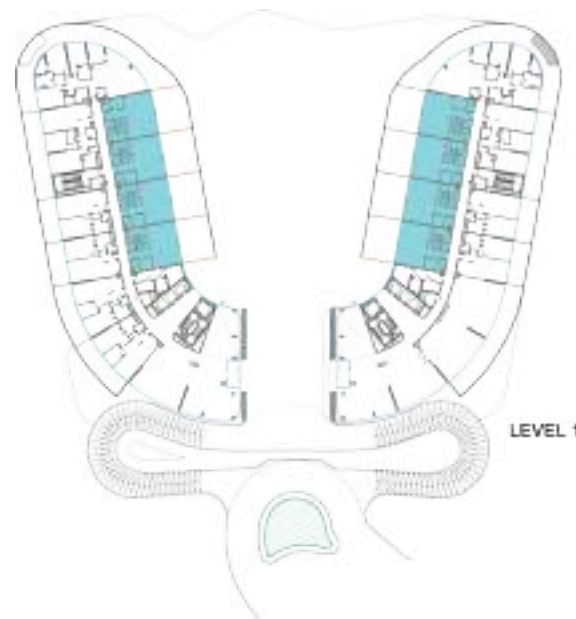

| | From | To |
|--------------|-----------------|-----------------|
| Suite Area | 1665.72 sq. ft. | 1693.161sq. ft. |
| Balcony Area | 800.94 sq. ft. | 817.63 sq. ft. |
| Total Area | 2466.66 sq. ft. | 2510.79 sq. ft. |

TOWNHOUSE

| | | |
|----|----------|----------------|
| 1 | PWD ROOM | 1.7m x 1.6m |
| 2 | BATH | 2.2m x 1.6m |
| 3 | LAUNDRY | 1.3m x 1.1m |
| 4 | STORE | 2.2m x 2.4m |
| 5 | KITCHEN | 2.6m x 5.4m |
| 6 | LIVING | 5.6m x 5.5m |
| 7 | BALCONY | MIN. 6.4m wide |
| 8 | BATH | 3m x 3m |
| 9 | BEDROOM | 4.0m x 4.4m |
| 10 | BATH | 2.9m x 2.0m |
| 11 | BEDROOM | 4.1m x 4.6m |
| 12 | BALCONY | MIN. 1.3m wide |

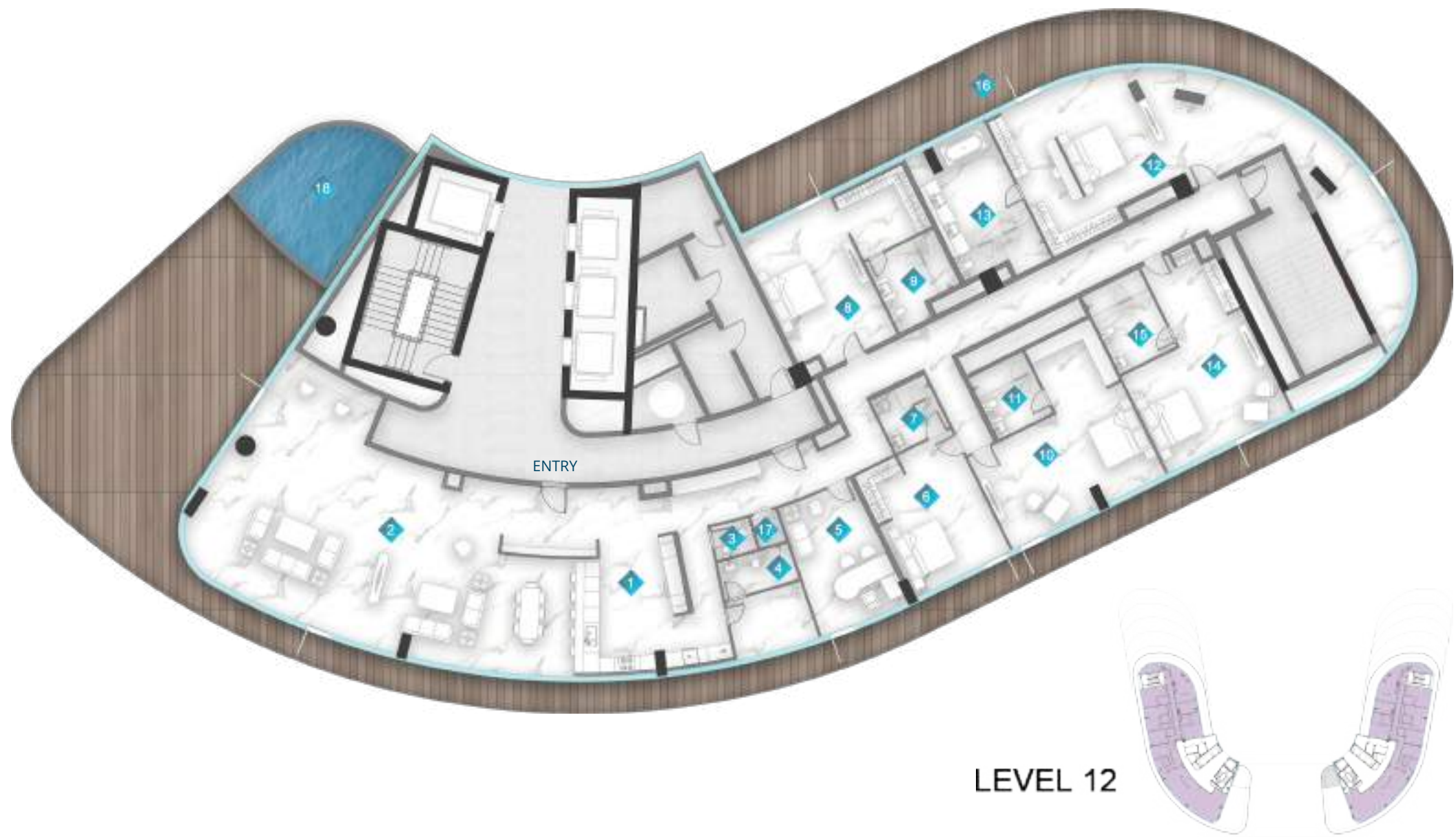

LEVEL 12

PENTHOUSE

| | | | | | |
|---|----------|--------------|----|--------------|--------------|
| 1 | KITCHEN | 6.3m x 5.2m | 10 | BEDROOM | 4.05m x 6.7m |
| 2 | LIVING | 16.3m x 7.4m | 11 | BATH | 2.4m x 2.7m |
| 3 | PWD ROOM | 1.6m x 1.2m | 12 | BEDROOM | 10.1m x 6m |
| 4 | BATH | 2.8m x 1.5m | 13 | BATH | 3.4m x 5.3m |
| 5 | STUDY | 3.6m x 5.3m | 14 | BEDROOM | 5.4m x 4.2m |
| 6 | BEDROOM | 4.2m x 3.1m | 15 | BATH | 2.5m x 3.4m |
| 7 | BATH | 2.3m x 2.3m | 16 | BALCONY | MIN. 1.2 m |
| 8 | BEDROOM | 4m x 6m | 17 | LAUNDRY | 1m x 1.2m |
| 9 | BATH | 3m x 2.4m | 18 | PRIVATE POOL | |

| | From | To |
|--------------|-----------------|-----------------|
| Suite Area | 5547.72 sq. ft. | 5549.44sq. ft. |
| Balcony Area | 3111.42 sq. ft. | 3111.52 sq. ft. |
| Total Area | 8659.14 sq. ft. | 8660.97 sq. ft. |

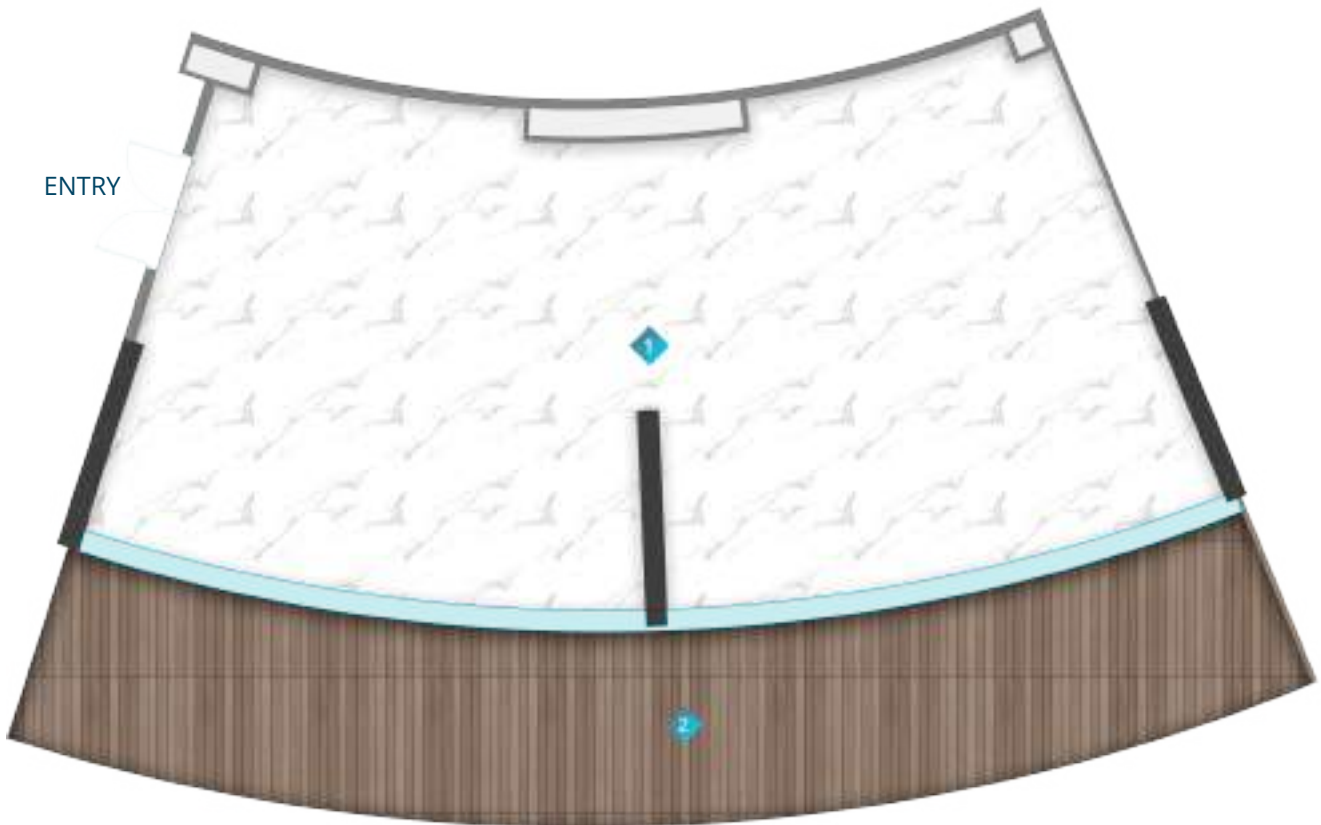

RETAIL

| | | |
|---|---------|--------------|
| 1 | RETAIL | 21.2m x 9.6m |
| 2 | BALCONY | 21.2m x 3.4m |

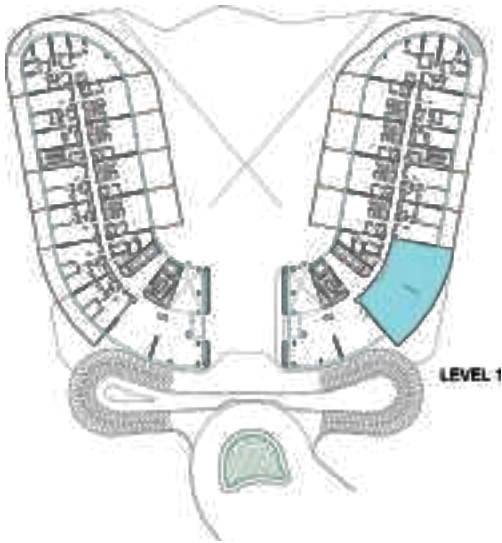

| | |
|--------------|-----------------|
| Suite Area | 1937.72sq. ft. |
| Balcony Area | 868.22 sq. ft. |
| Total Area | 2805.94 sq. ft. |

*All images used for illustrative purposes only and do not represent the actual size, feature specificatons, fitting, and furnishing. The developer reserves the right to make revision / alterations, at its absolute discretion, without any liability whatsoever.

FLOOR PLANS



GROUND FLOOR



LEVEL 1

- 1BR UNITS
- 2BR UNITS
- 3BR UNITS
- DUPLEX

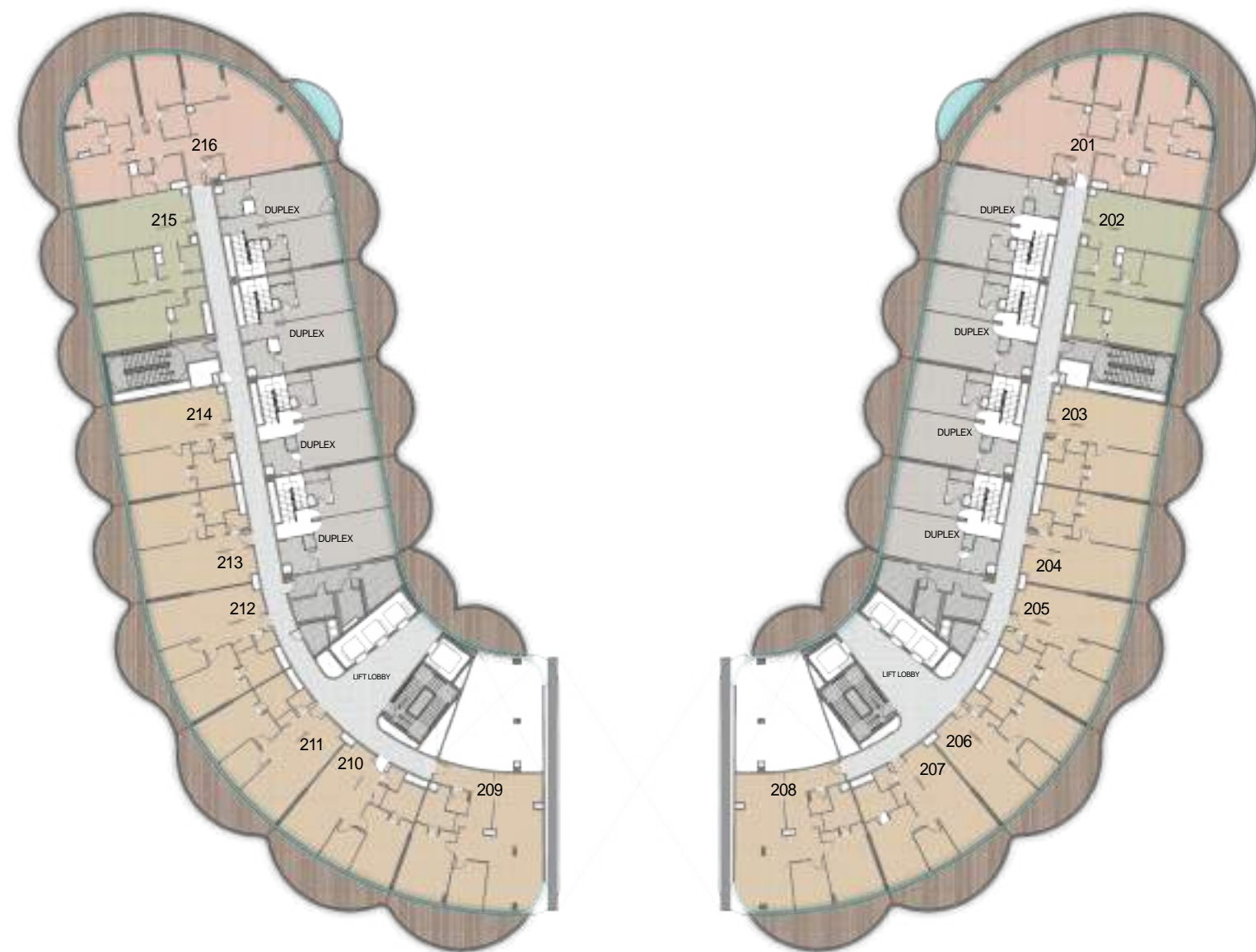

LEVEL 2

- 1BR UNITS
- 2BR UNITS
- 3BR UNITS
- DUPLEX

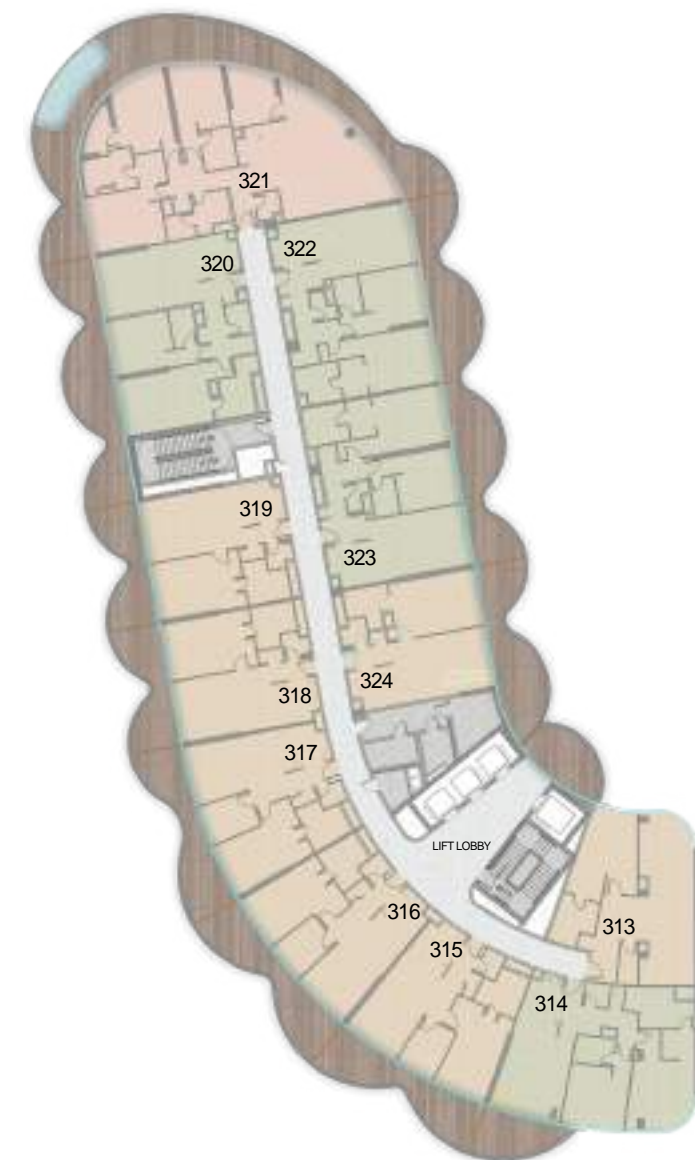

LEVEL 3

- 1BR UNITS
- 2BR UNITS
- 3BR UNITS

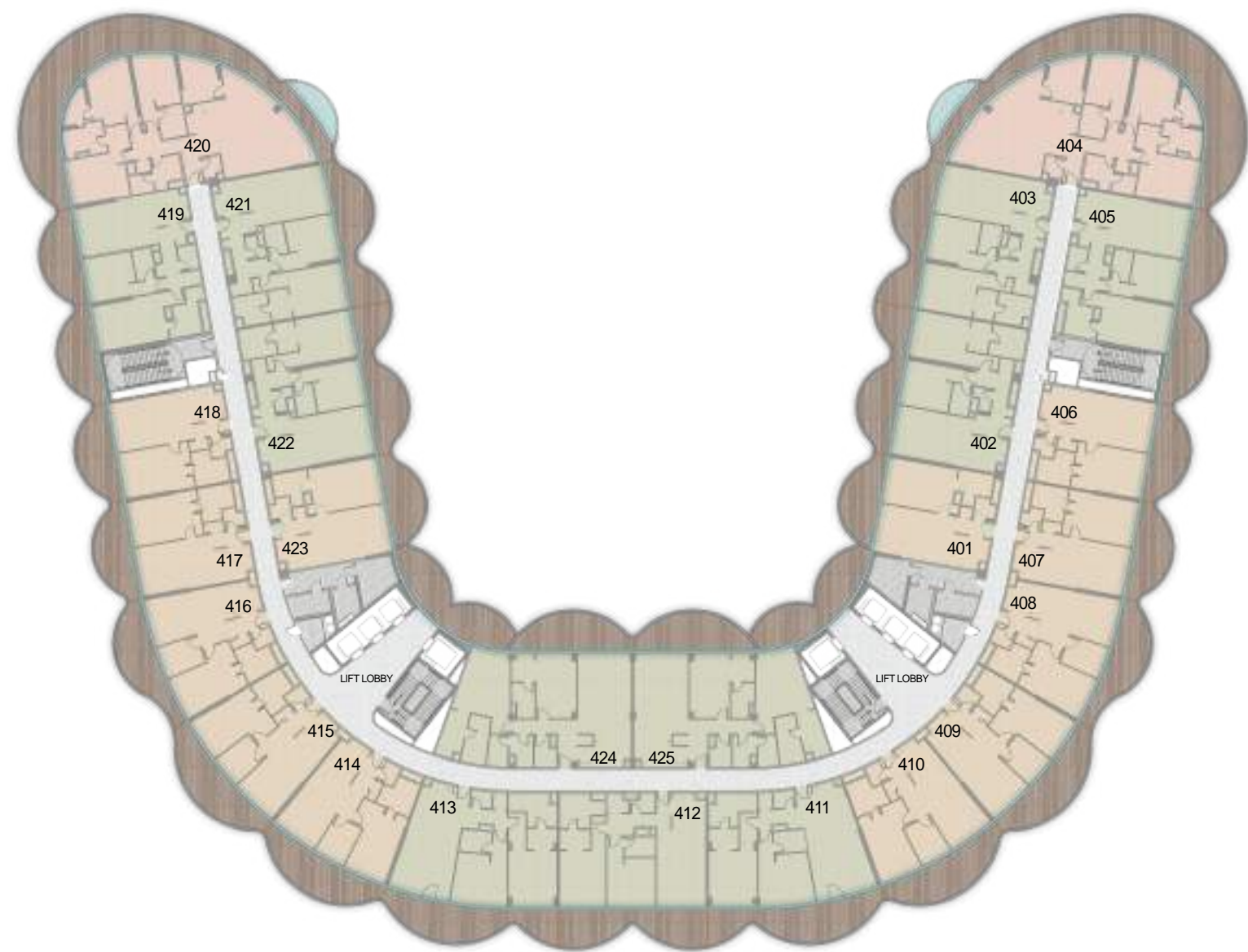

LEVEL 4

- 1BR UNITS
- 2BR UNITS
- 3BR UNITS

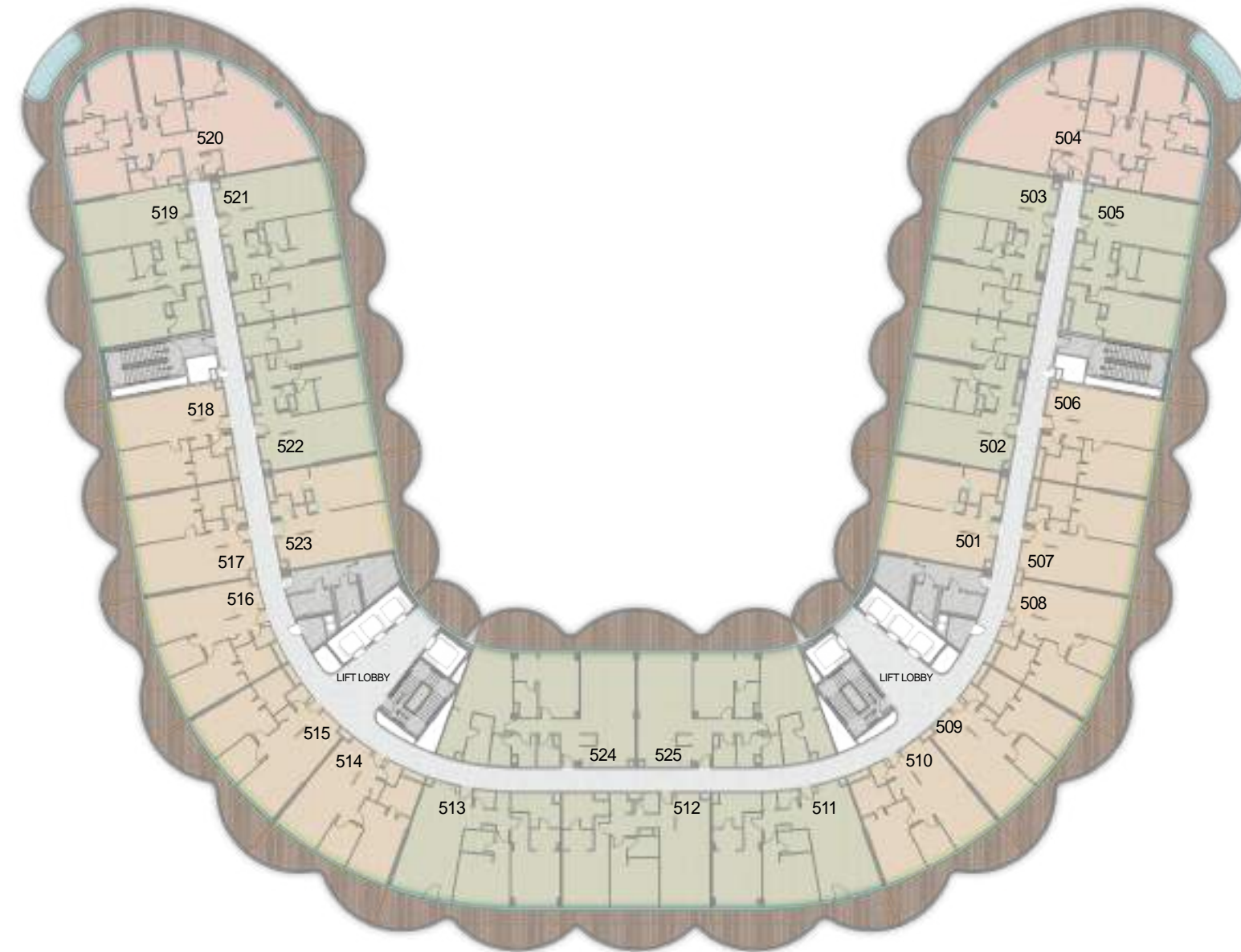

LEVEL 5

- 1BR UNITS
- 2BR UNITS
- 3BR UNITS

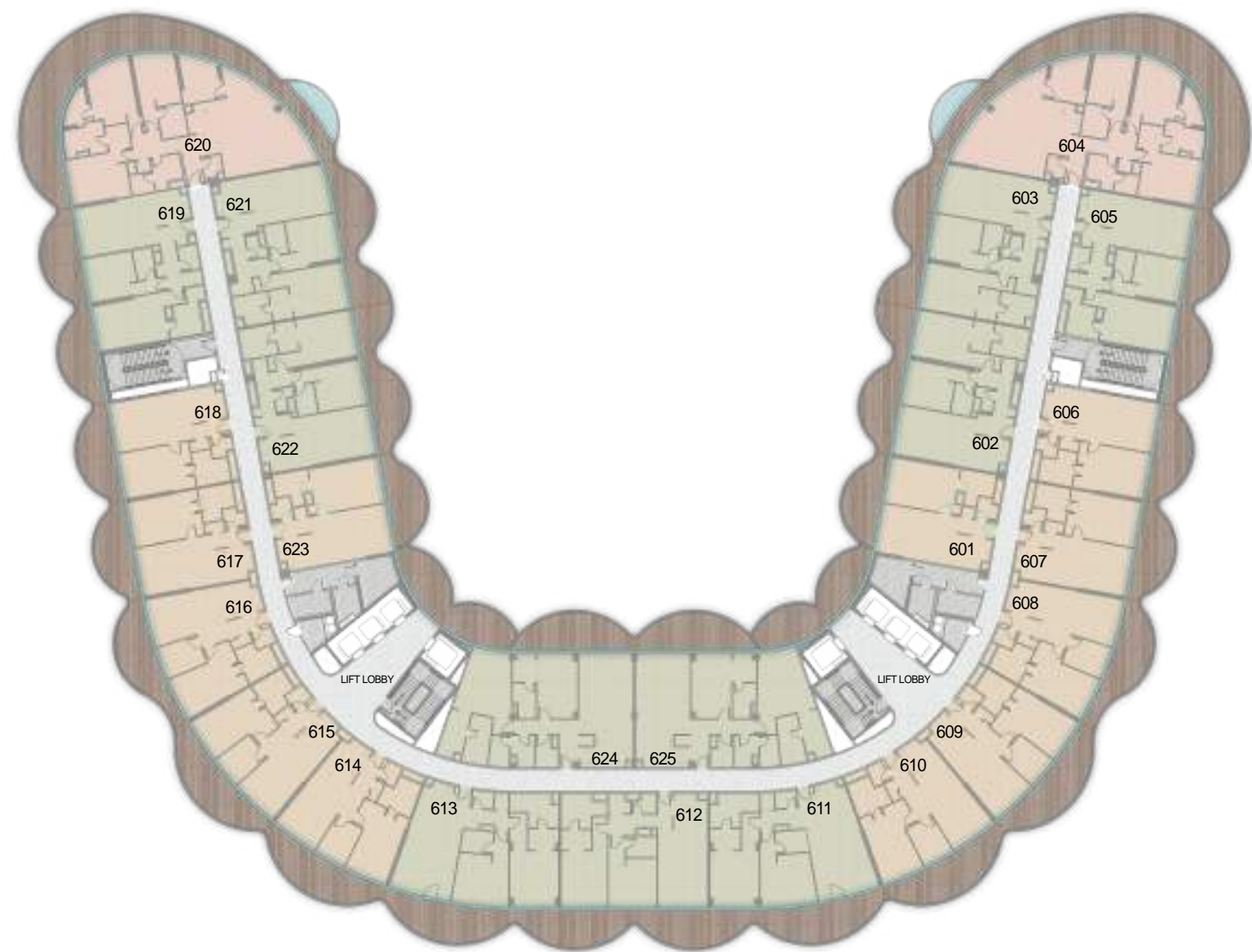

LEVEL 6

- 1BR UNITS
- 2BR UNITS
- 3BR UNITS

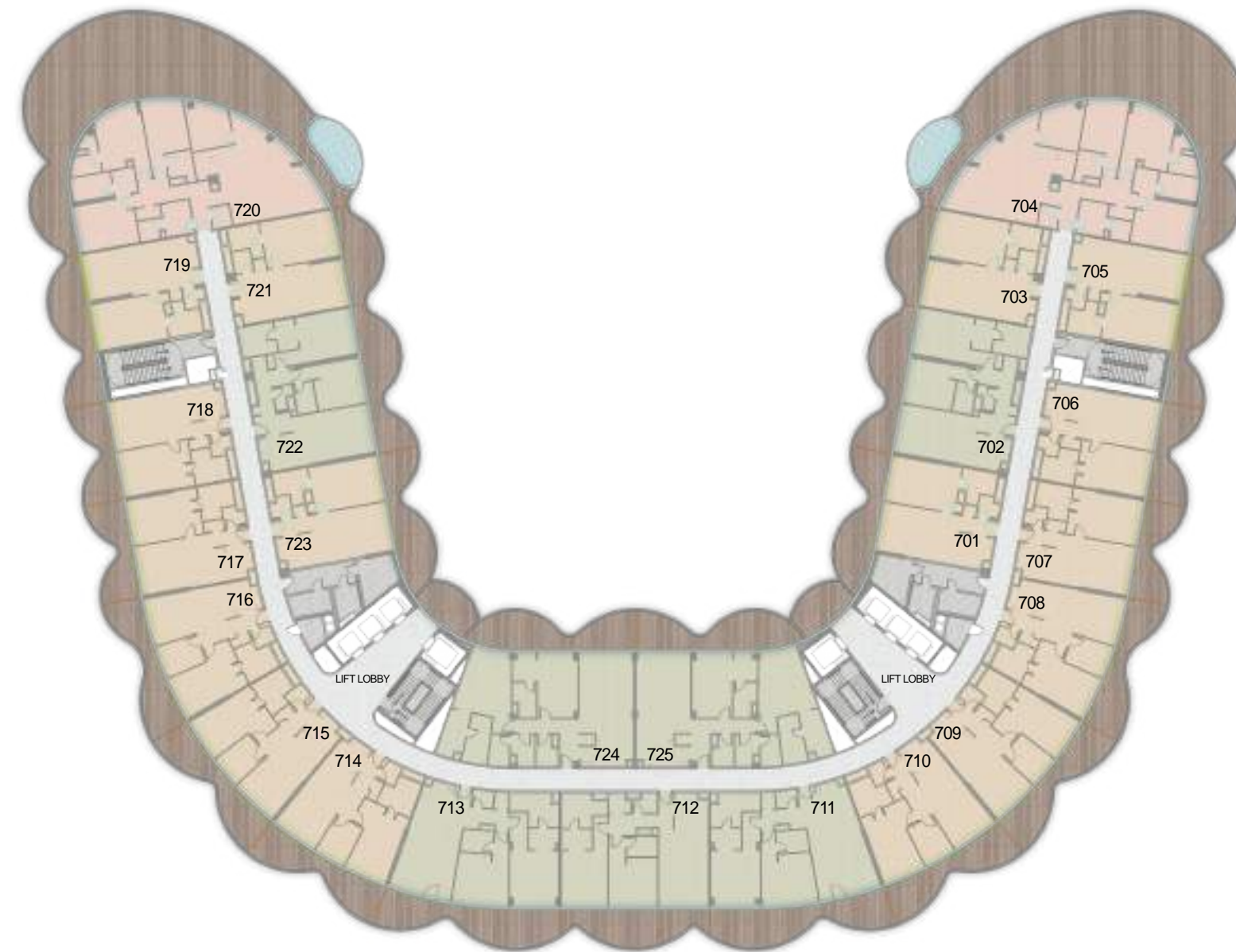

LEVEL 7

- 1BR UNITS
- 2BR UNITS
- 3BR UNITS

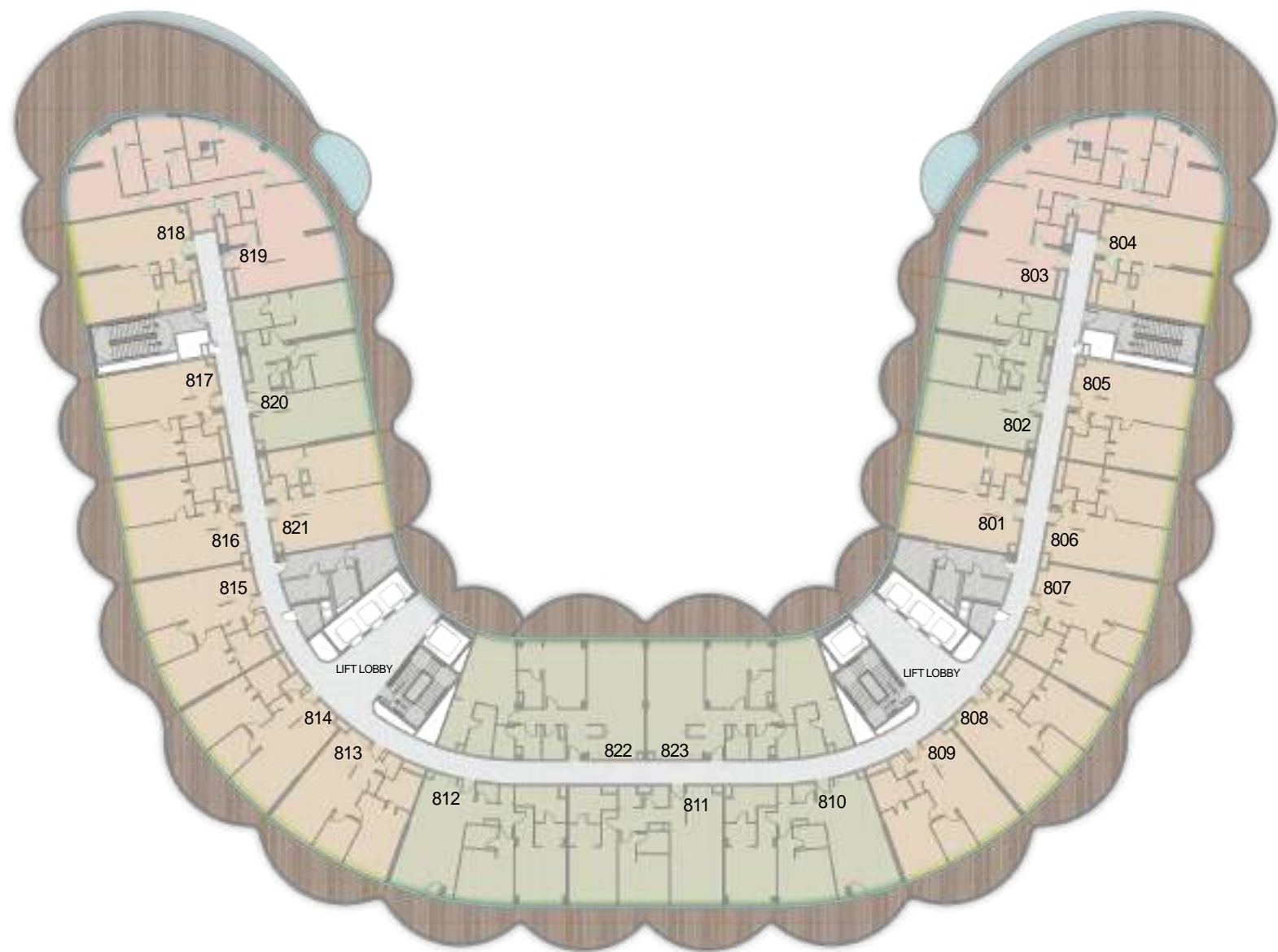

LEVEL 8

- 1BR UNITS
- 2BR UNITS
- 3BR UNITS

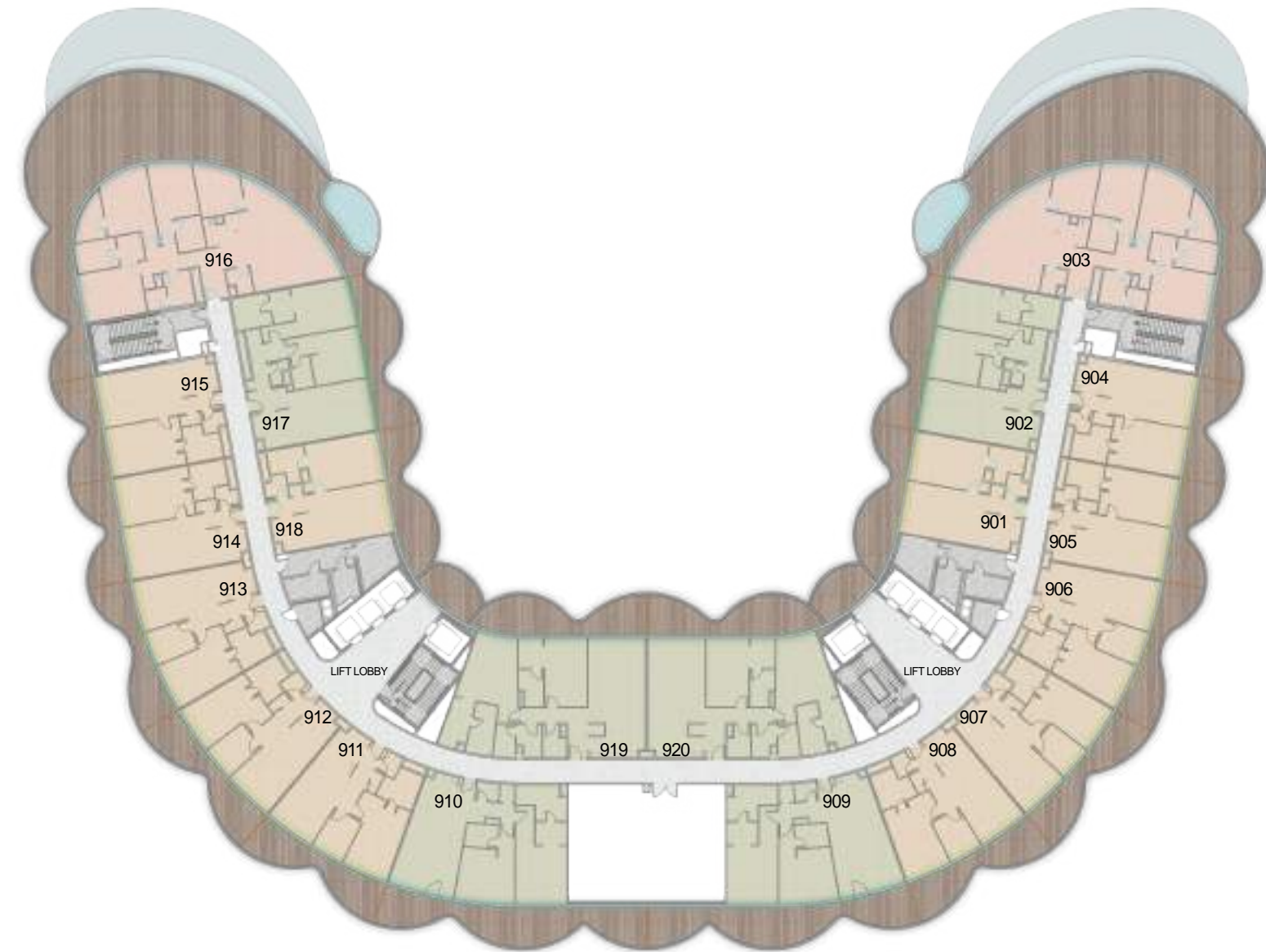

LEVEL 9

- 1BR UNITS
- 2BR UNITS
- 3BR UNITS

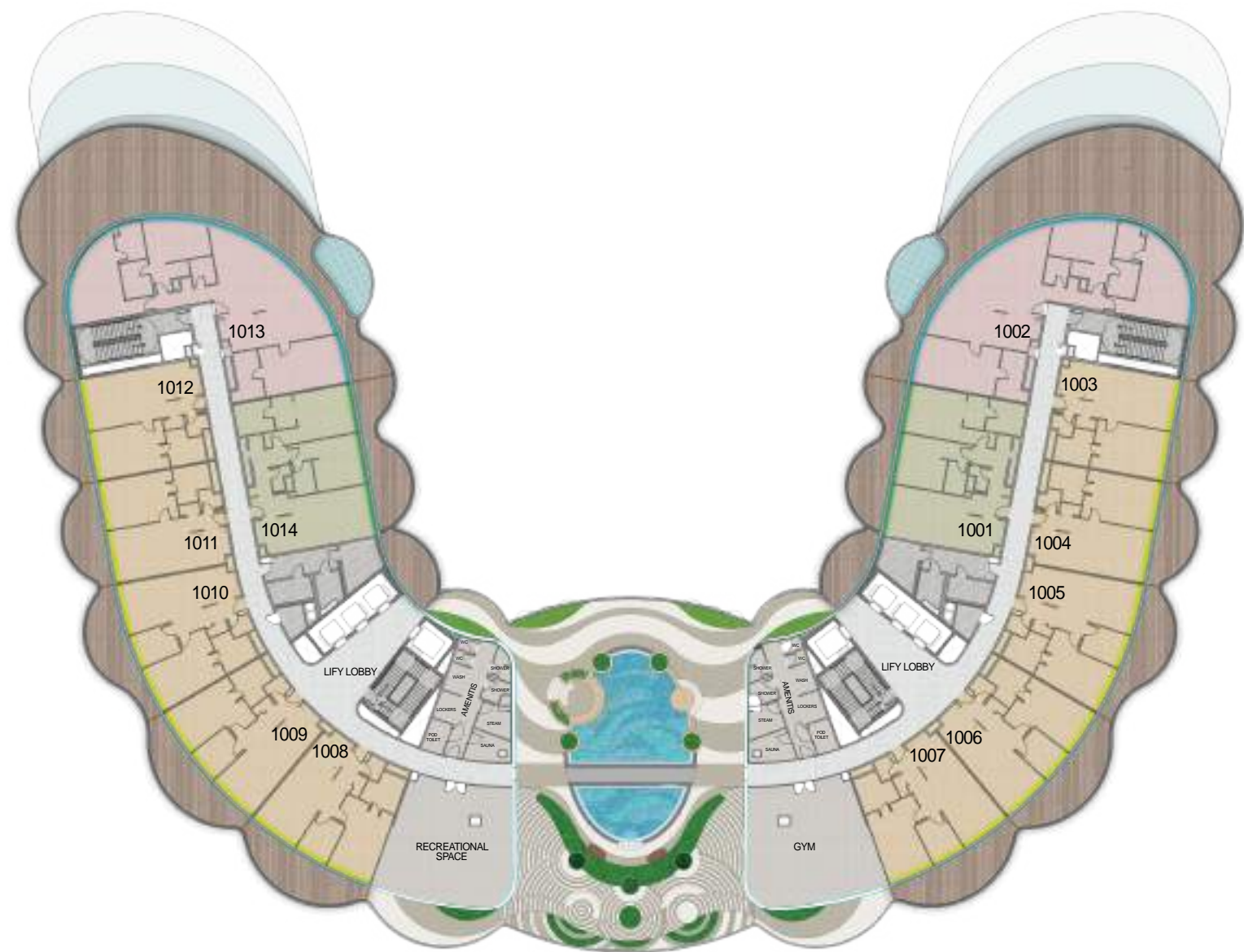

LEVEL 10

- 1BR UNITS
- 2BR UNITS
- 3BR UNITS

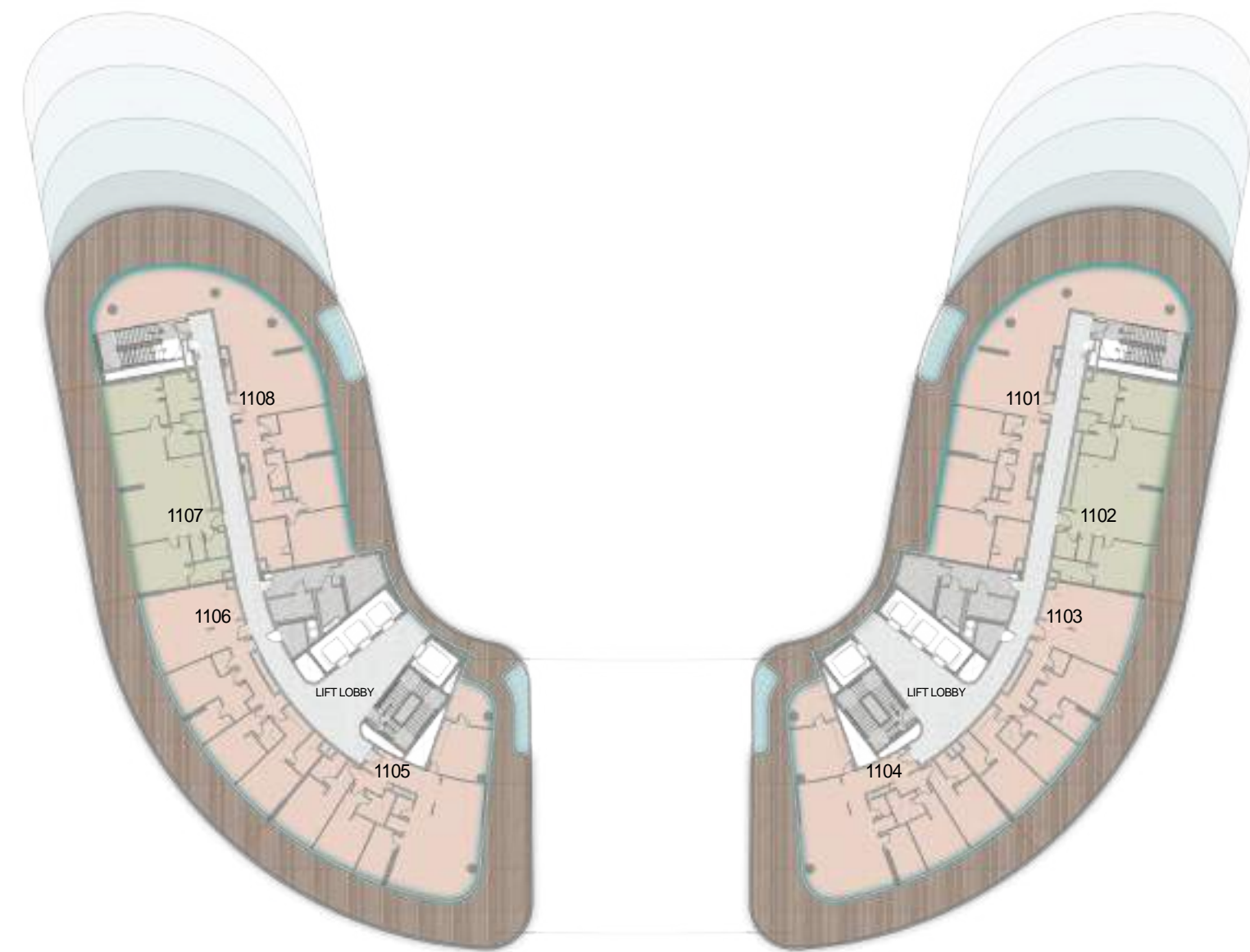

LEVEL 11

- 1BR UNITS
- 2BR UNITS
- 3BR UNITS



PENTHOUSES

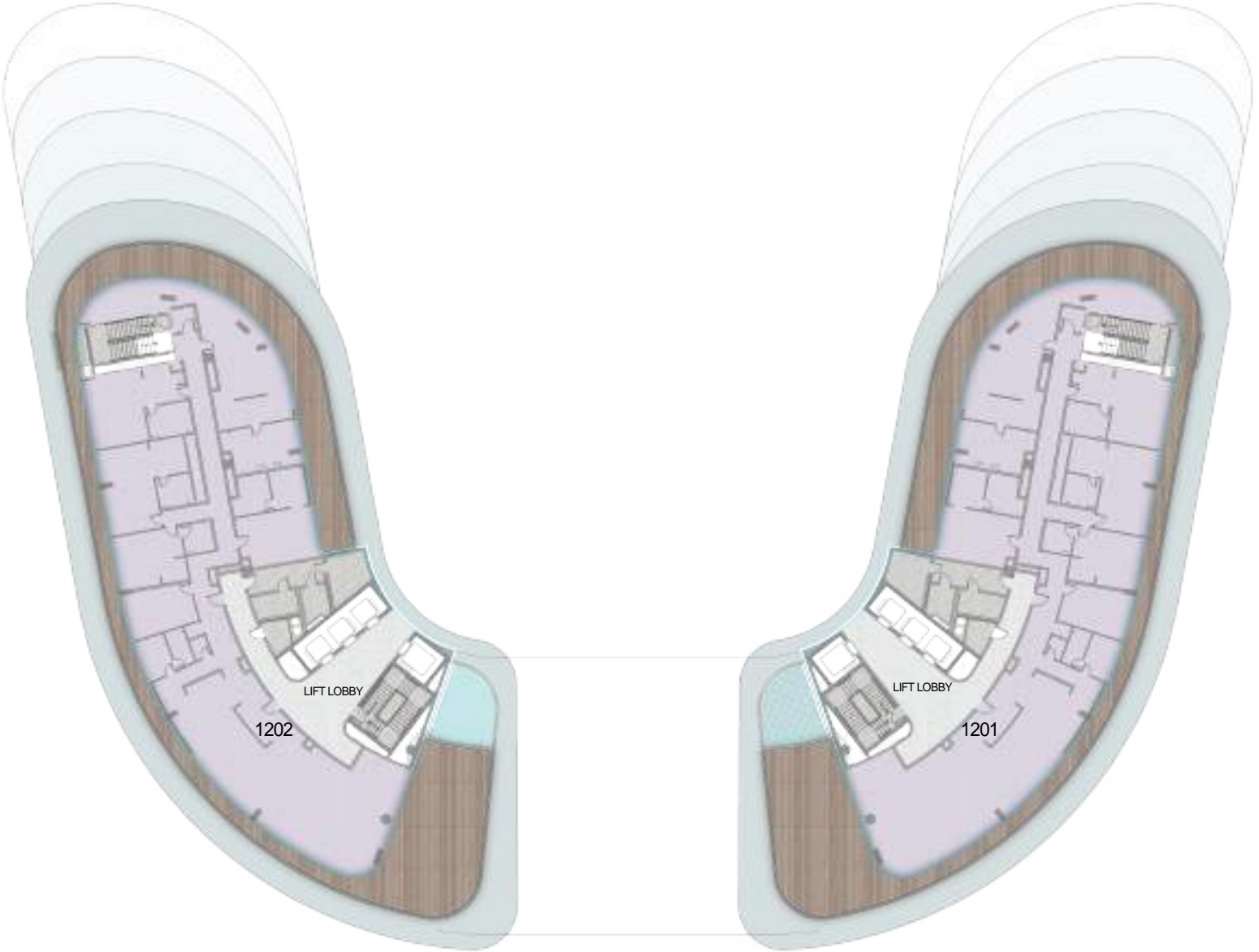

PENTHOUSES

*All images used for illustrative purposes only and do not represent the actual size, feature specifications, fitting, and furnishing. The developer reserves the right to make revision / alterations, at its absolute discretion, without any liability whatsoever.





BNW DEVELOPMENTS
بي ان دبليو للتطوير العقاري

24th & 33rd Floor, Ubora Tower, Business Bay, Dubai, UAE

☎ 800 BNWUAE 🌐 www.bnw.ae ✉ info@bnw.ae





THANKS FOR WATCHING

CONTACT US FOR MORE INFORMATION

 www.svrealstate.agency

 [svrealstate_agency](https://t.me/svrealstate_agency)

 [svrealstate_agency](https://wa.me/svrealstate_agency)

 svrealstate@agency

 +9 909 999 99 99