



YOU ARE A GUIDE TO THE  
WORLD OF LUXURY



**HAMILTON**  
RESIDENCY  
BUSINESS BAY



## Home and office next door!

In the heart of Business Bay, Dubai's prestigious corporate hub, is a haven of comfort and luxury. A residential address specially created for a successful person like you, who gives it a hundred percent at work, but will not compromise on quality time with the family.

Get the best of both worlds. Easy accessibility between home and work. The time you spend caught in traffic commuting to and from work, can now be spent in the swimming pool with your children. Or, enjoying a quiet dinner at home! And, when a meeting comes up unexpectedly, you know you're just a hop away!



HAMILTON  
RESIDENCY  
BUSINESS BAY



## Hamilton Towers Home and office next door!

- Faces scenic lake views and landscape development.
- In close proximity to Burj Dubai “The Worlds Tallest Tower” and Dubai Mall having a massive shopping center entrenched with 5 star property.
- Few minutes from Al Khail Road.



- 16 floors of well planned apartments • 1 bedroom apartments
- Designed to exacting European standards • Superior fixtures and finishes in every room
- State-of-the-art facilities and amenities





## Get quality time at home and work



With life getting hectic day after day, you probably find that work makes unreasonable demands on your time, leaving you feeling stretched and stressed. Having a home close to your office helps you strike the right balance. So you can work hard and play hard!

You can now enjoy all the good things of life that you never found time for. Catch up with friends, unwind with music, indulge in outdoor activities with the children, go shopping, get a taste of the new restaurants in town... all this, within easy distance of your home.



State-of-the-art amenities  
to compliment your lifestyle



Facilities available round the clock  
to help you unwind

- Roof (Podium Level) Garden with Swimming Pool, Spa, Outdoor sitting & B.B.Q. area
  - Multi-purpose Hall/Aerobics
  - Fully equipped Gymnasium
    - Squash Court
  - Sauna, Steam and Lockers.
  - 24-hours Security system
    - CCTV system
- High Speed Internet connectivity
  - Access Control system
  - Central Air-conditioning
  - Fire Alarm system



The look that makes a statement



Stylish detailing and user friendly finishes make the difference

	Floor	Walls
Ground Floor		
Entrance Lobby	Granite/ Marble	Granite/ Marble
Typical Floor		
Lift Lobby/ Corridor	Granite/ Marble	High Quality Paint Finish
Living/ Dining	Quality Tiles	High Quality Paint Finish
Bed Rooms	Quality Tiles	High Quality Paint Finish
Kitchen	Quality Tiles	Quality Tiles
Toilets	Quality Tiles	Quality Tiles

Kitchen : Furnished with Cabinets, Granite Counter Top and set Stainless Steel Sink.

Bed Room : Furnished with Built-in Closets.

Toilet : Furnished with Fixtures & Granite Counter.

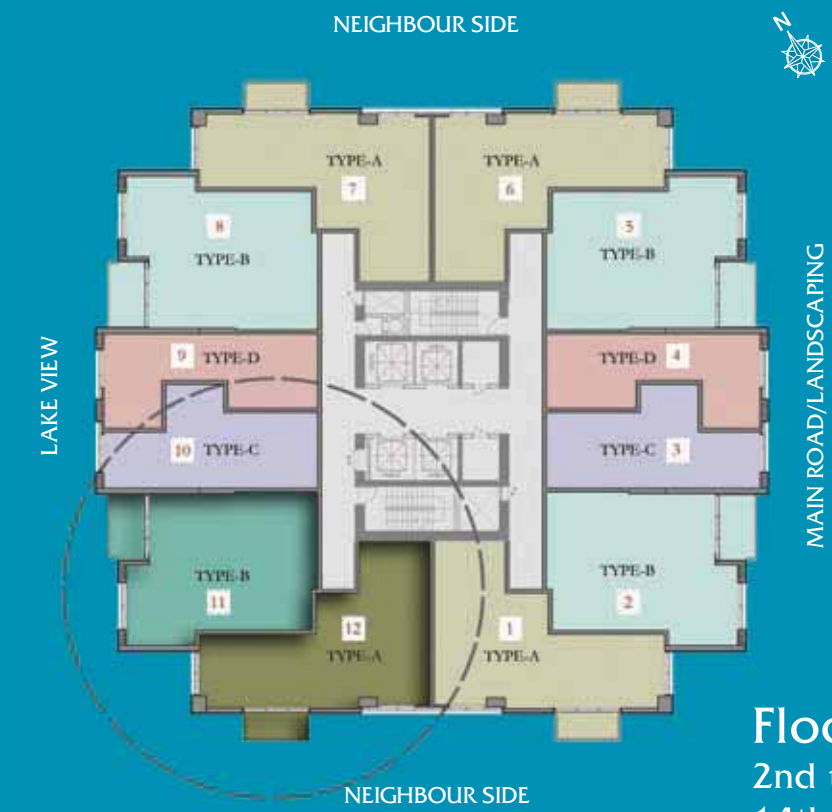

**Floor Plan**  
 2nd to 12th Floor  
 14th to 16th Floor  
 1 Bedroom Apartments

**Type B**  
 One Bedroom Apt.  
 87.14 sq.mt  
 937.94 sq.ft  
 Apt. Nos. 2,5,8 & 11



**Type A**  
 One Bedroom Apt.  
 86.55 sq.mt  
 931.69 sq.ft  
 Apt. Nos. 1,6,7 & 12



Apartment Type	Space Name & Areas				
	Living/Dining	Master Bed Room	Kitchen	Balcony	
Type A One Bed Room Apartment	6.00x3.95	3.70x4.30	2.40x2.7	5.25 sq.mt	Meters
	19.69x12.96	12.14x14.11	7.87x8.86	56.51 sq.ft	Feet
Type B One Bed Room Apartment	6.90x4.30	4.50x3.70	2.90x2.10	7.58 sq.mt	Meters
	22.64x14.11	14.76x12.14	9.51x6.89	81.59 sq.ft	Feet

Note: Dimensions are approximate due to space/walls orientation



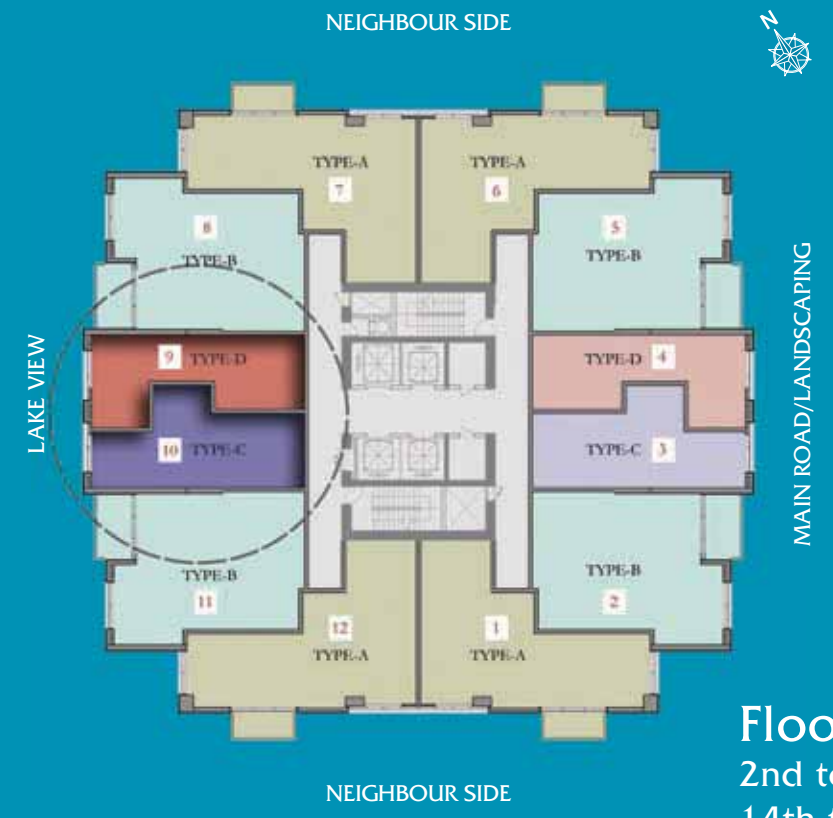

**Floor Plan**  
 2nd to 12th Floor  
 14th to 16th Floor  
 1 Bedroom Apartments

**Type D**  
 One Bedroom Apt.  
 49.51 sq.mt  
 532.91 sq.ft  
 Apt. Nos. 4 & 9



**Type C**  
 One Bedroom Apt.  
 52.27 sq.mt  
 562.62 sq.ft  
 Apt. Nos. 3 & 10

Apartment Type		Space Name & Areas			
		Living/Dining	Master Bed Room	Kitchen	Balcony
Type C	One Bed Room Apartment	6.50x3.00	3.10x2.50	2.30x2.70	Meters
		21.33x9.84	10.17x8.20	7.54x8.86	Feet
Type D	One Bed Room Apartment	6.60x2.50	3.10x2.50	2.20x2.70	Meters
		21.65x8.20	10.17x8.20	7.22x8.86	Feet

Note: Dimensions are approximate due to space/walls orientation

# Deyaar

Communities that enrich lives

At Deyaar, we pride on our achievements of having efficiently built and successfully delivered a portfolio of development projects. We bring a fresh approach to planning and development to create unique communities that enrich lives. We will build communities that preserve the natural environment around us, while harnessing the newest technologies and encouraging sustainable development.



Call 800-DEYAAR (800-339227)  
[www.deyaar.ae](http://www.deyaar.ae)



دييار  
DEYAAR

Call 800-DEYAAR (800-339227)  
[www.deyaar.ae](http://www.deyaar.ae)

# THANKS FOR WATCHING

CONTACT US FOR MORE INFORMATION