

YOU ARE A GUIDE TO THE  
WORLD OF LUXURY





# HILLMONT

R E S I D E N C E S

JUMEIRAH VILLAGE CIRCLE



Welcome to

# HILLMONT

R E S I D E N C E S

CRAFTING SPACES  
THAT INSPIRE





# EMBARKING ON A JOURNEY TO REDEFINE URBAN LIVING

Hillmont Residences is Ellington's newest development in Jumeirah Village Circle, the project epitomizes modern living amidst the circular topography of the community. Its design is more than just aesthetics; it's a reflection of the vibrant community it resides in. The layering of materials and textures pays homage to the diverse landscape of the community, creating a visually stunning masterpiece that seamlessly blends with its surroundings.







# CREATING VISUALLY CAPTIVATING SPACES

---

It is a 12-storey residential building comprising a diverse range of apartment types ranging from studios, and 1 to 3-bedroom apartments. Beyond that, Hillmont Residences fosters a vibrant community spirit with open social spaces and top-notch amenities, inviting residents to connect and thrive – Every aspect of Hillmont Residences embodies contemporary comfort and timeless elegance, offering an unparalleled lifestyle experience in the heart of Jumeirah Village Circle.





## CONCENTRIC SEQUENCE

---

The exterior facade of the building stands as a testament to the thoughtful integration of architecture with the surrounding community. Through a meticulous layering of materials and textures, the facade pays homage to the diverse landscape of the community, capturing its essence in every detail.



ELEVATING THE  
STANDARDS OF  
EXCELLENCE







Each element of the design is carefully chosen to reflect the richness and dynamism of the environment. From the sleek lines that echo the modernity of Jumeirah Village Circle to the earthy tones that harmonize with the natural beauty of the surroundings, every aspect of the facade is imbued with meaning.





# DRIVING DISTANCES

03 MINUTES | FIVE JUMEIRAH VILLAGE CIRCLE

07 MINUTES | CIRCLE MALL

12 MINUTES | DUBAI HILLS MALL

15 MINUTES | DUBAI HILLS GOLF CLUB

19 MINUTES | MALL OF THE EMIRATES

19 MINUTES | BUSINESS BAY

19 MINUTES | JUMEIRAH GOLF ESTATE

21 MINUTES | DUBAI MARINA

21 MINUTES | BURJ AL ARAB

21 MINUTES | JUMEIRAH BEACH

22 MINUTES | DUBAI MALL AND BURJ KHALIFA

23 MINUTES | PALM JUMEIRAH

24 MINUTES | DUBAI INTERNATIONAL FINANCIAL CENTRE

30 MINUTES | DUBAI INTERNATIONAL AIRPORT

30 MINUTES | DUBAI WORLD CENTRAL AIRPORT

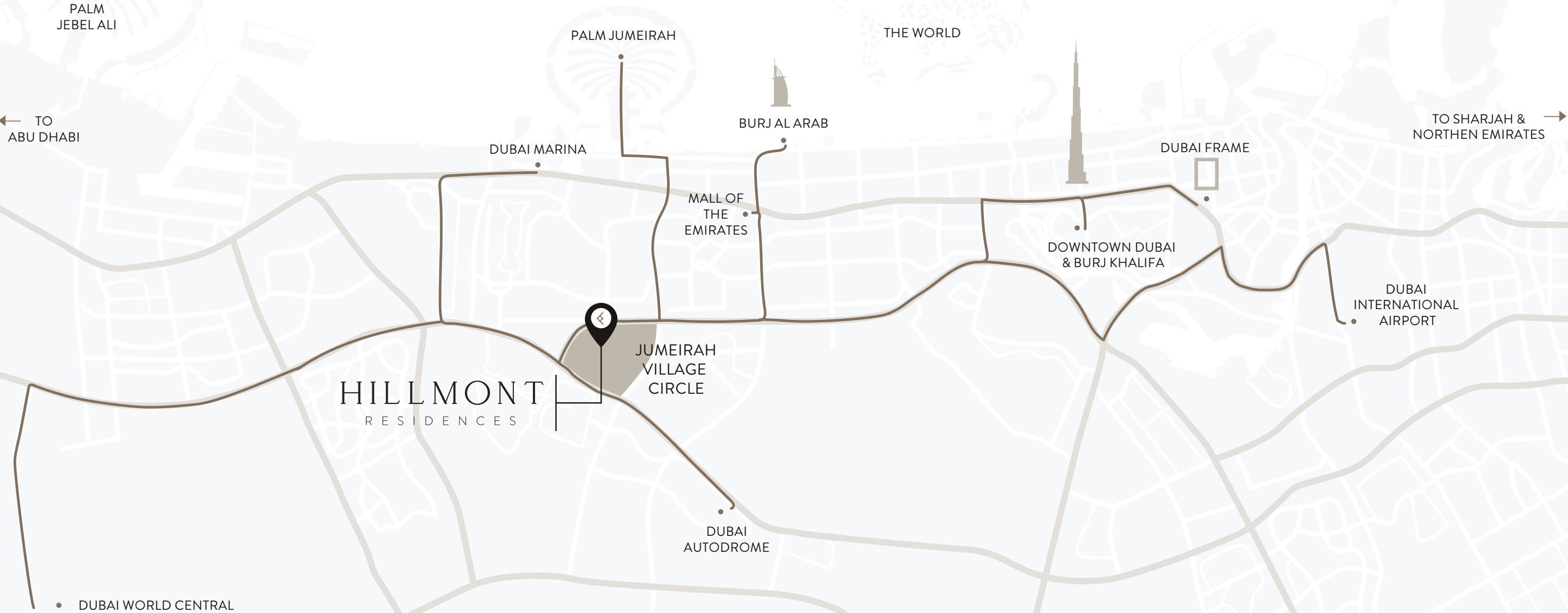



# ELLINGTON'S PORTFOLIO IN JUMEIRAH VILLAGE CIRCLE



## HILLMONT RESIDENCES

AL BARSHA

AL BARSHA 2

AL KHAIL ROAD

EATON PLACE

AL KHAIL ROAD

SOMERSET MEWS

OAKLEY

HYPER MARKET

CIRCLE MALL

HESA STREET



Harrington House



BELGRAVIA III

FIVE JVC

CIRCLE COMMUNITY PARK

DISTRICT PARK

DISTRICT PARK

NURSERY SCHOOL



PORTMAN



BELGRAVIA II

NURSERY SCHOOL

COMMUNITY PARK

KAHRABA S RD

NURSERY SCHOOL



THE SLOANE



BELGRAVIA HEIGHTS I



BELGRAVIA I

BELGRAVIA Square



HAMILTON HOUSE

SHEIKH MOHAMMED BIN ZAYED ROAD





## WHERE CONNECTIONS FLOURISH

---

The lobby serves as a captivating blend of sophistication and comfort, offering a warm welcome to residents and guests alike. At its heart stands a striking marble reception desk, a focal point of elegance and functionality. Sunlight floods the space through expansive floor-to-ceiling windows, blurring the lines between indoors and outdoors.





ELLINGTON

HILLMONT  
RESIDENCES

CAFE







---

The neutral color palette, complemented by subtle metallic blue accents, adds a touch of contemporary flair to the surroundings. Within the Lobby Lounge, inspired by the finest in hospitality design, a variety of seating options cater to diverse needs, whether it's for relaxation, socializing, or work. Adorning the walls are original art pieces, carefully selected from the Ellington Art Foundation's collection, infusing the space with cultural depth and artistic vibrancy.







ELLINGTON  
PROPERTIES

THE LOBBY



# GROUND FLOOR AMENITIES PLAN

- 1 LOBBY ENTRANCE
- 2 LOBBY LOUNGE
- 3 LOBBY RECEPTION
- 4 LIFT LOBBY
- 5 EV CHARGING STATION
- 6 BICYCLE PARKING
- 7 DOG WASH AREA
- 8 PARKING FOR PEOPLE OF DETERMINATION
- 9 ACCESS TO PARKING ENTRANCE
- 10 ACCESS TO UPPER PARKING
- 11 PEDESTRIAN PATHWAY
- 12 OUTDOOR SEATING AREAS



GROUND  
FLOOR





---

Step into our enchanting play area and prepare to be taken away on a journey of wonder and delight. As children enter this captivating space, they are greeted by colors and a symphony of laughter echoing through the air.



# A WHOLE NEW ADVENTURE AWAITS

---

From the cozy kids' size seating areas adorned with plush cushions to the interactive play zones bursting with excitement, every element is thoughtfully designed to ignite the imagination and a sense of wonder. With décors scattered throughout, this magical playground invites young adventurers to explore, create, and make memories that will last a lifetime.







---

The Clubhouse, nestled within the residence, offers a stylish retreat for residents. Featuring modular seating and book displays, it's perfect for meetings and events. With direct access to the pool and coworking space, it seamlessly blends leisure and productivity. Two soundproof telephone pods cater to privacy or focused work. The striking ceiling design and porcelain floors exude sophistication.







## CLUBHOUSE

Residents can reserve the space for private events, enjoying ample natural light and the signature Ellington Hospitality scent throughout.





---

Surrounded by a row of sun loungers, each one thoughtfully shaded, the pool invites moments of relaxation and leisure. The pool deck is bordered by sleek glass panels, creating a seamless transition between the pool deck and the rest of the outdoors, offering a private sanctuary from the bustling world beyond.





## POOL DECK

Through the transparent wall, one can glimpse the vibrant community beyond, adding an element of connection to the serene ambiance.





---

The Fitness Studio, perched with an expansive view of the pool and lush landscape, serves as the epicenter of wellness within the residence. Furnished with top-of-the-line fitness equipment sourced from renowned and eco-conscious brands, its layout is meticulously designed to optimize every workout.







# A JOURNEY INTO WELLNESS

---

Natural light floods the space through full-height glazing and bifold doors, with roller blinds offering customizable lighting and temperature control. From state-of-the-art cardio machines to Pilates machines and punching bags, the studio boasts amenities that include yoga balls, mat holders, and a sanitization station. Ambient music and the signature Ellington Hospitality scent enhance the atmosphere, making every session a rejuvenating experience.



# 1<sup>ST</sup> FLOOR AMENITIES PLAN

- 1 LEISURE & LOUNGE POOL
- 2 WADING POOL
- 3 SUN LOUNGERS AREA
- 4 SHOWER DECK
- 5 OUTDOOR LOUNGE
- 6 CLUB LOUNGE
- 7 PHONE BOOTH/CO-WORKING CORNER
- 8 INDOOR KIDS PLAY AREA
- 9 KIDS WASHROOM
- 10 OUTDOOR KIDS PLAY
- 11 KIDS POOL
- 12 KIDS POOL DECK
- 13 FEMALE CHANGE & SAUNA ROOM
- 14 MALE CHANGE & SAUNA ROOM
- 15 FITNESS STUDIO
- 16 MULTI-PURPOSE LAWN
- 17 LIFT LOBBY



1<sup>ST</sup> FLOOR



# THE RESIDENCES







---

The living room is the epitome of comfort and conviviality, designed to be the perfect gathering spot for family and guests alike. With its opulent design and inviting atmosphere, it beckons for moments of relaxation and connection. Whether it's unwinding with a book, enjoying lively conversations by the views through the floor-to-ceiling windows, or simply basking in the warmth of natural light, this space offers an unparalleled sense of serenity and ease.





## LIVING & DINING

The living room effortlessly accommodates every occasion, becoming the heart of the home where cherished memories are made and shared.





---

Step into the kitchen, a hub of culinary inspiration and warmth. With its open layout and sleek design, it beckons for both casual breakfast chats and gourmet cooking adventures. The grey marble countertops and light wood cabinetry exude modern elegance, while the spacious bar kitchen island offers a perfect spot for gathering and eating.







## KITCHENS

The kitchen is more than just a space for preparing meals—it's a place where memories are savored, making it the heart of the home.





---

The bedroom exudes a harmonious blend of style and serenity, inviting you to unwind from the moment you step inside. Your gaze is immediately drawn to the expansive balcony, a serene retreat that promises moments of tranquility amidst the outdoors.



A modern bedroom interior featuring a large window on the left side, offering a view of a city skyline. The room includes a bed with a light-colored headboard and blue and white bedding. A large, curved rug is placed under the bed. To the right, there are tall wardrobes with integrated mirrors and open shelving. The ceiling has a circular light fixture. The overall design is sleek and contemporary.

## BEDROOMS

The wardrobes stand tall, their sleek design is a testament to meticulous attention to detail. With durable laminated doors and integrated mirrors, they effortlessly combine practicality with sophistication.





---

In the bathroom, every detail is meticulously curated to create a haven of sophistication and practicality. The high-quality faucets and accessories not only add a touch of elegance but also ensure a seamless experience with every use. Porcelain floor and wall tiles provide a timeless backdrop, while the generous 2.4-meter ceiling height adds to the feeling of spaciousness and comfort. Custom-designed mirror medicine cabinets and under-sink storage, complete with concealed lighting, offer ample space for organization without compromising on style.

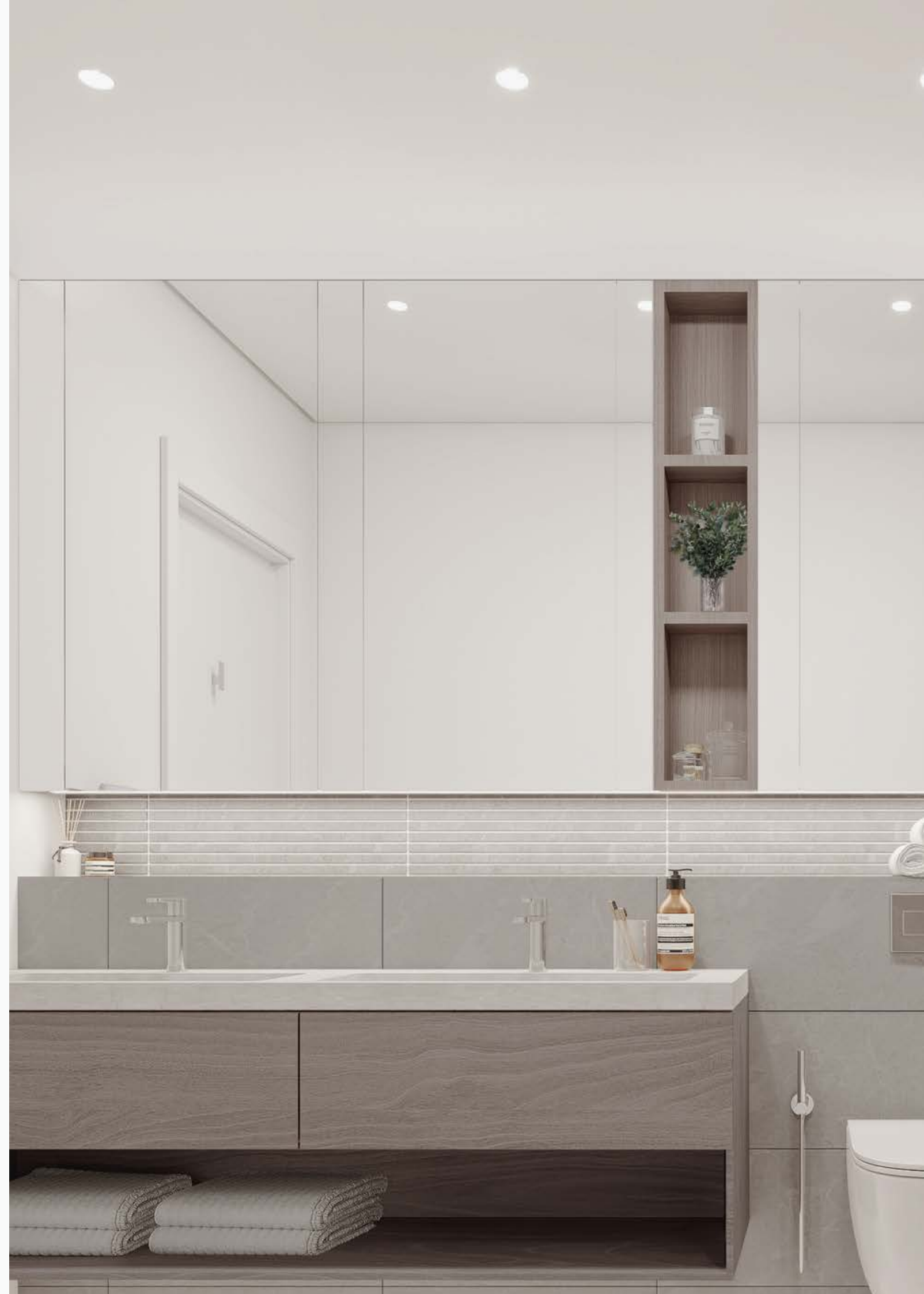





## BATHROOMS

Glass door partitions with sleek metal framing separate the showers, enhancing the contemporary aesthetic of the room. The premium quartz stone countertops provide a durable and lavish surface for daily grooming rituals.



# FLOOR PLAN



# STUDIO

TYPE A



## 2<sup>ND</sup> - 3<sup>RD</sup> FLOOR

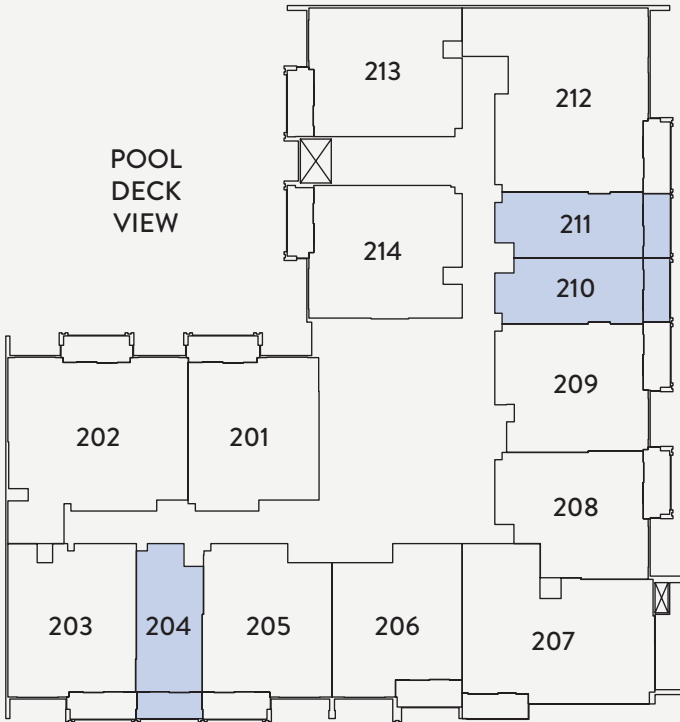

## 1<sup>ST</sup> FLOOR

02 09  
08

## 2<sup>ND</sup> - 3<sup>RD</sup> FLOOR

04 11  
10

## 4<sup>TH</sup> - 5<sup>TH</sup> FLOOR

09  
10

INTERNAL LIVING AREA - 381.47 SQ. FT

OUTDOOR LIVING AREA - 70.83 SQ. FT

TOTAL LIVING AREA - 452.30 SQ. FT



# 1 BEDROOM

TYPE A



2<sup>ND</sup> - 3<sup>RD</sup> FLOOR

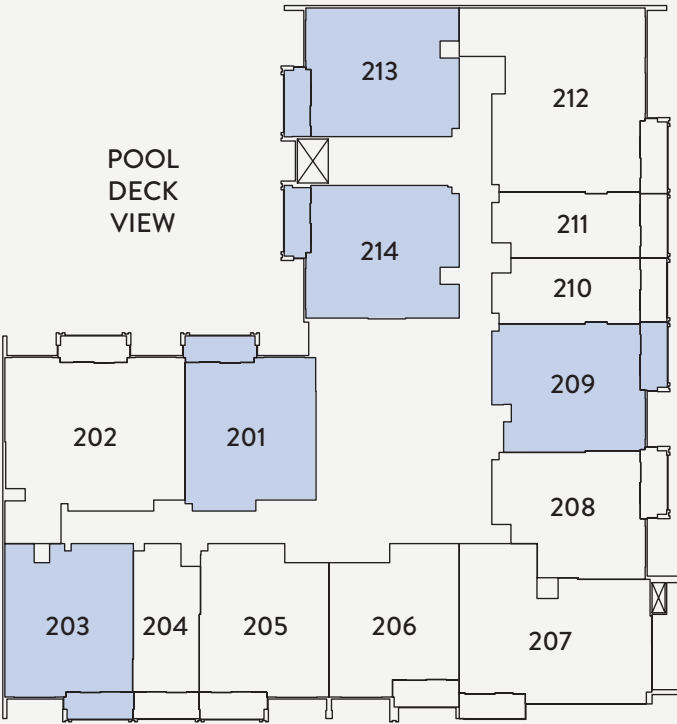

1<sup>ST</sup> FLOOR

01  
07

2<sup>ND</sup> - 3<sup>RD</sup> FLOOR

01 09 14  
03 13

4<sup>TH</sup> - 5<sup>TH</sup> FLOOR

01 12  
08 13

6<sup>TH</sup> - 8<sup>TH</sup> FLOOR

01 11  
08 12

9<sup>TH</sup> - 10<sup>TH</sup> FLOOR

01 10  
07 11

11<sup>TH</sup> FLOOR

01 10  
07 11

12<sup>TH</sup> FLOOR

01 10  
07 11

INTERNAL LIVING AREA - 755.63 SQ. FT

OUTDOOR LIVING AREA - 73.95 SQ. FT

TOTAL LIVING AREA - 829.57 SQ. FT



# 1 BEDROOM

TYPE B



2<sup>ND</sup> - 3<sup>RD</sup> FLOOR

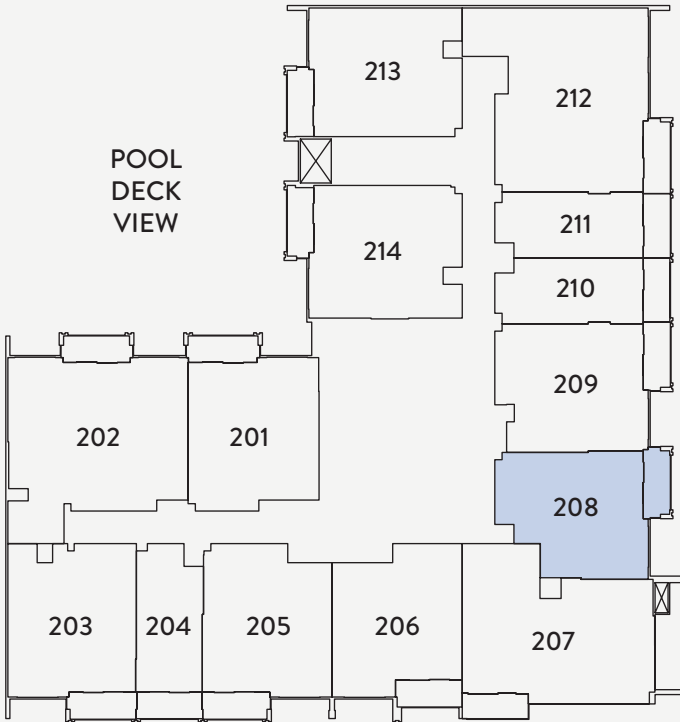

1<sup>ST</sup> FLOOR  
06

2<sup>ND</sup> - 3<sup>RD</sup> FLOOR  
08

4<sup>TH</sup> - 5<sup>TH</sup> FLOOR  
07

6<sup>TH</sup> - 8<sup>TH</sup> FLOOR  
07

INTERNAL LIVING AREA - 696.32 SQ. FT

OUTDOOR LIVING AREA - 74.38 SQ. FT

TOTAL LIVING AREA - 770.70 SQ. FT



# 1 BEDROOM

## TYPE C

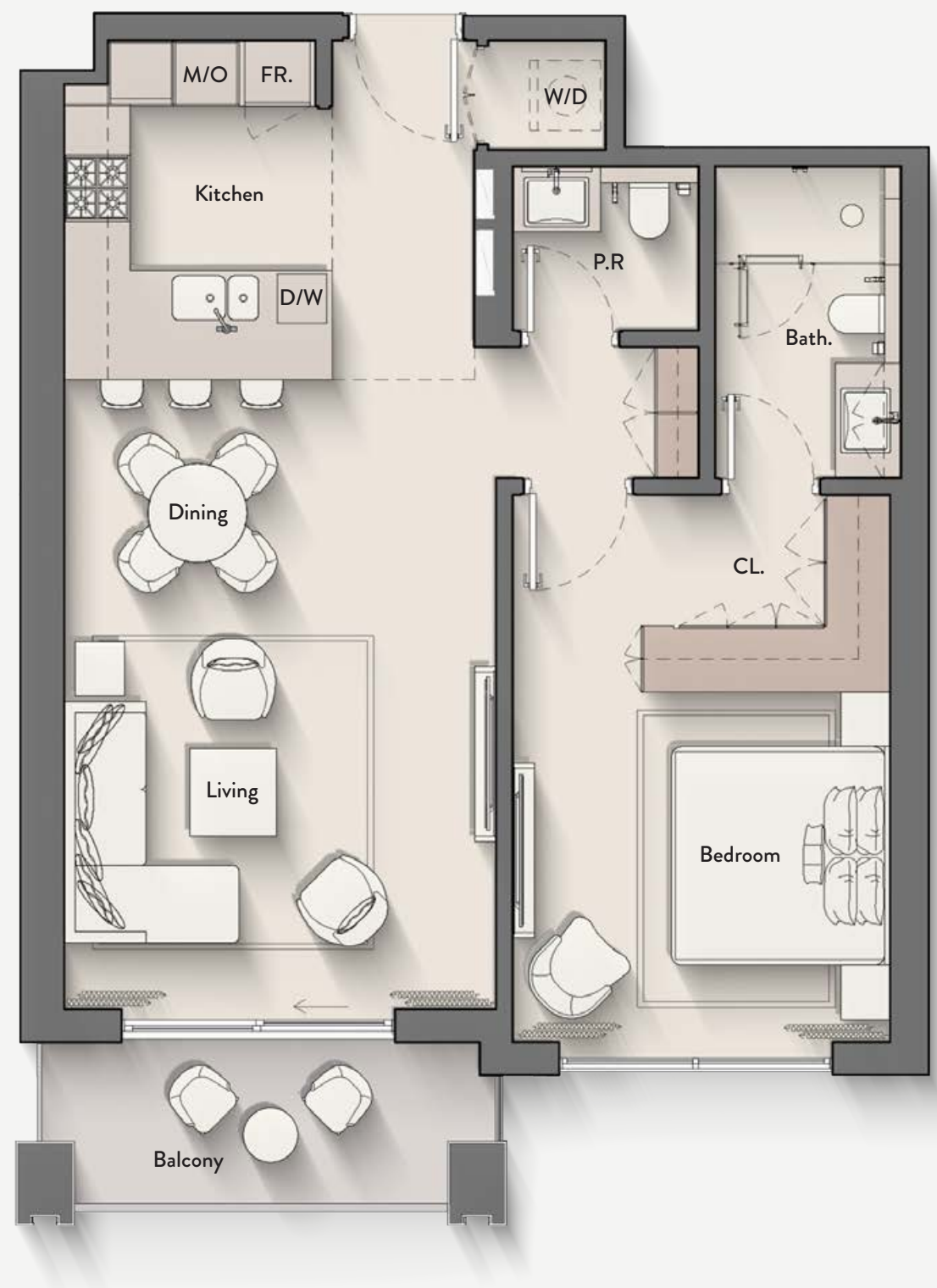

### 2<sup>ND</sup> - 3<sup>RD</sup> FLOOR

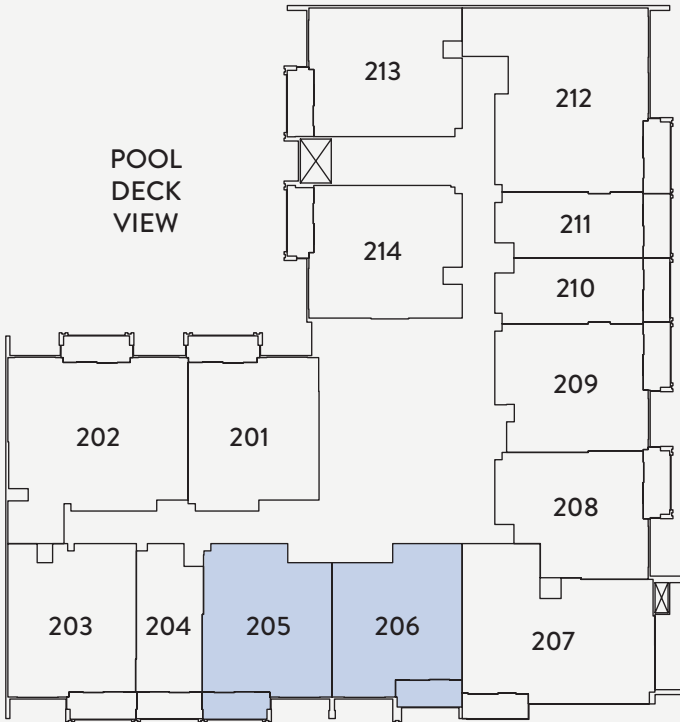

### 1<sup>ST</sup> FLOOR

03  
04

### 4<sup>TH</sup> - 5<sup>TH</sup> FLOOR

04  
05

### 9<sup>TH</sup> - 10<sup>TH</sup> FLOOR

04  
05

### 12<sup>TH</sup> FLOOR

04  
05

### 2<sup>ND</sup> - 3<sup>RD</sup> FLOOR

05  
06

### 6<sup>TH</sup> - 8<sup>TH</sup> FLOOR

04  
05

### 11<sup>TH</sup> FLOOR

04  
05

INTERNAL LIVING AREA - 756.06 SQ. FT

OUTDOOR LIVING AREA - 73.63 SQ. FT

TOTAL LIVING AREA - 829.68 SQ. FT



# 1 BEDROOM

TYPE D



6<sup>TH</sup> - 8<sup>TH</sup> FLOOR

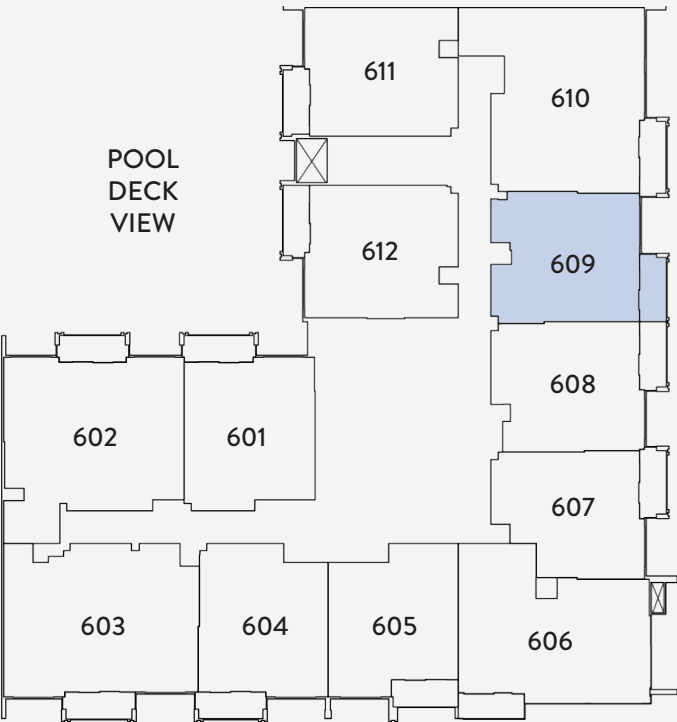

6<sup>TH</sup> - 8<sup>TH</sup> FLOOR  
09

9<sup>TH</sup> - 10<sup>TH</sup> FLOOR  
08

11<sup>TH</sup> FLOOR  
08

12<sup>TH</sup> FLOOR  
08

INTERNAL LIVING AREA - 760.47 SQ. FT

OUTDOOR LIVING AREA - 73.19 SQ. FT

TOTAL LIVING AREA - 833.66 SQ. FT



# 2 BEDROOM

## TYPE A



1<sup>ST</sup> FLOOR

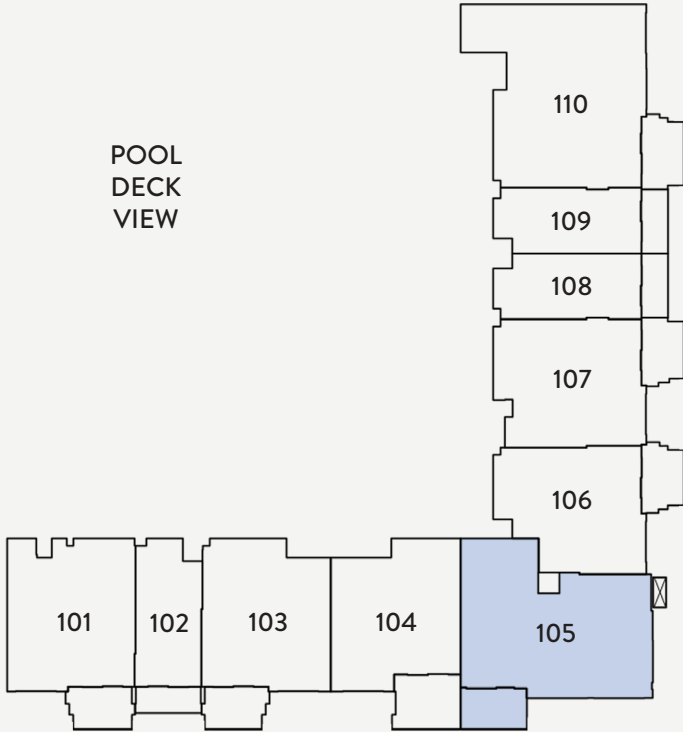

1<sup>ST</sup> FLOOR  
05

2<sup>ND</sup> - 3<sup>RD</sup> FLOOR  
07

4<sup>TH</sup> - 5<sup>TH</sup> FLOOR  
06

6<sup>TH</sup> - 8<sup>TH</sup> FLOOR  
06

INTERNAL LIVING AREA - 1040.98 SQ. FT

OUTDOOR LIVING AREA - 110.22 SQ. FT

TOTAL LIVING AREA - 1151.20 SQ. FT



# 2 BEDROOM

## TYPE B



### 2<sup>ND</sup> - 3<sup>RD</sup> FLOOR

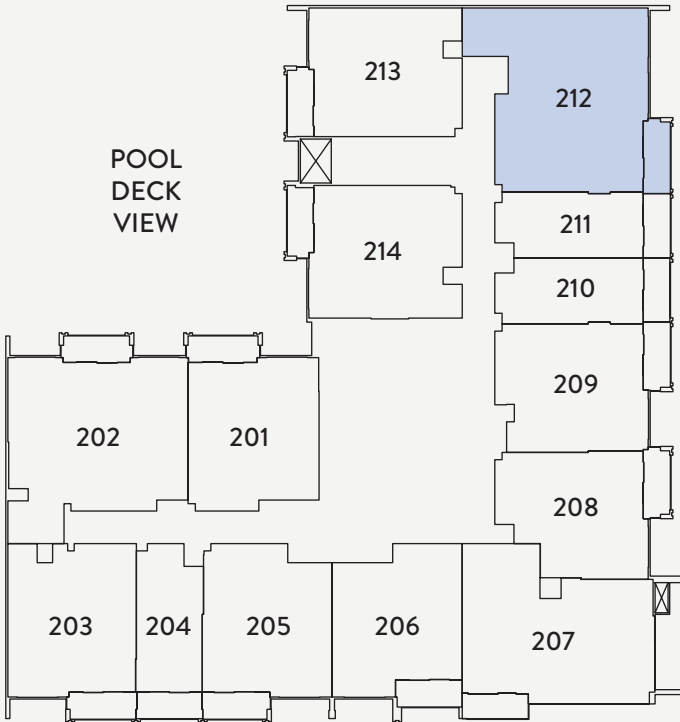

1<sup>ST</sup> FLOOR  
10

2<sup>ND</sup> - 3<sup>RD</sup> FLOOR  
12

4<sup>TH</sup> - 5<sup>TH</sup> FLOOR  
11

6<sup>TH</sup> - 8<sup>TH</sup> FLOOR  
10

9<sup>TH</sup> - 10<sup>TH</sup> FLOOR  
09

11<sup>TH</sup> FLOOR  
09

12<sup>TH</sup> FLOOR  
09



INTERNAL LIVING AREA - 1176.28 SQ. FT

OUTDOOR LIVING AREA - 80.84 SQ. FT

TOTAL LIVING AREA - 1257.12 SQ. FT



# 2 BEDROOM

## TYPE C



### 4<sup>TH</sup> - 5<sup>TH</sup> FLOOR

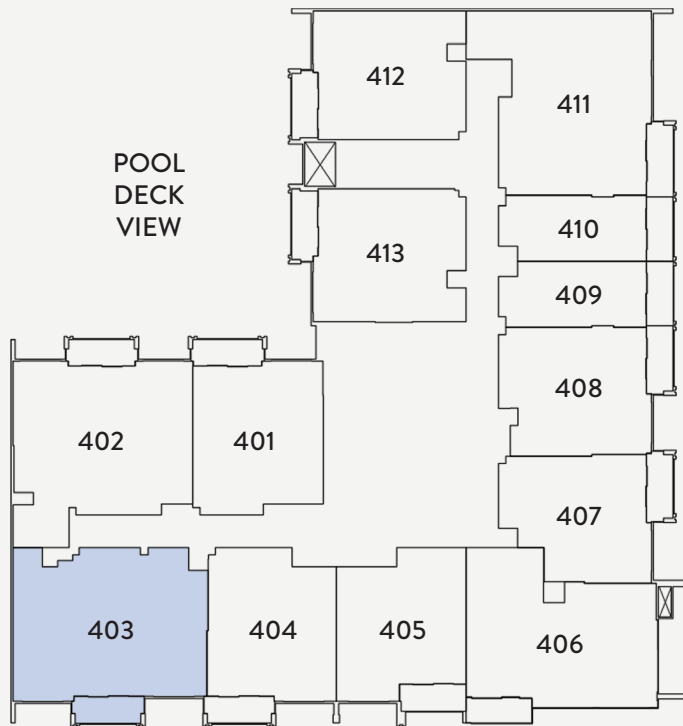

4<sup>TH</sup> - 5<sup>TH</sup> FLOOR  
03

6<sup>TH</sup> - 8<sup>TH</sup> FLOOR  
03

9<sup>TH</sup> - 10<sup>TH</sup> FLOOR  
03

11<sup>TH</sup> FLOOR  
03

12<sup>TH</sup> FLOOR  
03

INTERNAL LIVING AREA - 1148.83 SQ. FT

OUTDOOR LIVING AREA - 76.85 SQ. FT

TOTAL LIVING AREA - 1225.69 SQ. FT



# 2 BEDROOM + S

TYPE A



2<sup>ND</sup> - 3<sup>RD</sup> FLOOR

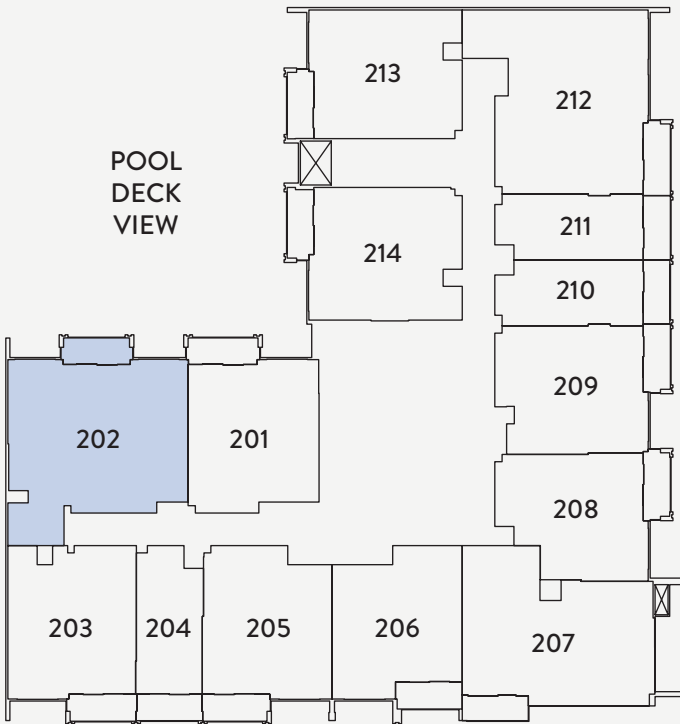

2<sup>ND</sup> - 3<sup>RD</sup> FLOOR  
02

4<sup>TH</sup> - 5<sup>TH</sup> FLOOR  
02

6<sup>TH</sup> - 8<sup>TH</sup> FLOOR  
02

9<sup>TH</sup> - 10<sup>TH</sup> FLOOR  
02

11<sup>TH</sup> FLOOR  
02

12<sup>TH</sup> FLOOR  
02

INTERNAL LIVING AREA - 1158.09 SQ. FT

OUTDOOR LIVING AREA - 74.38 SQ. FT

TOTAL LIVING AREA - 1232.47 SQ. FT



# 3 BEDROOM

## TYPE A



9<sup>TH</sup> - 10<sup>TH</sup> FLOOR

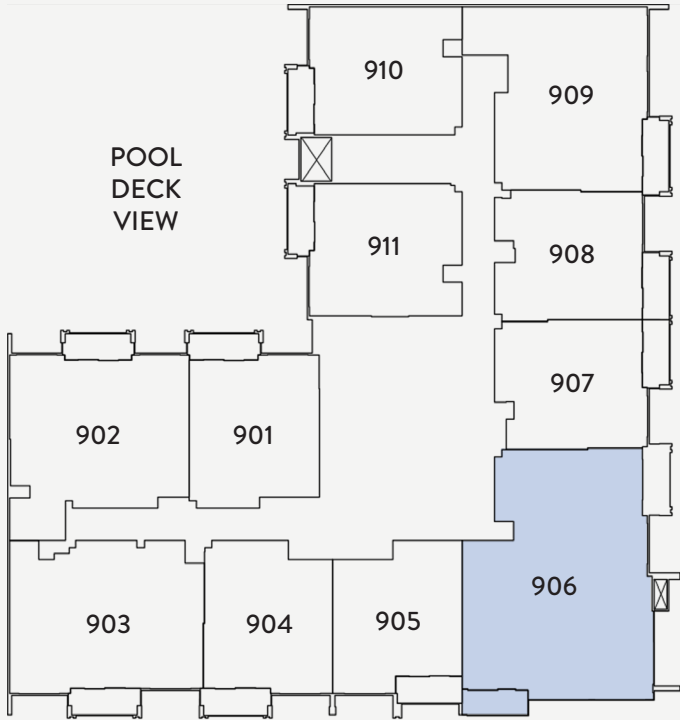

9<sup>TH</sup> - 10<sup>TH</sup> FLOOR  
06

INTERNAL LIVING AREA - 1737.94 SQ. FT

OUTDOOR LIVING AREA - 67.38 SQ. FT

TOTAL LIVING AREA - 1805.32 SQ. FT



# 3 BEDROOM

## TYPE B



11<sup>TH</sup> FLOOR

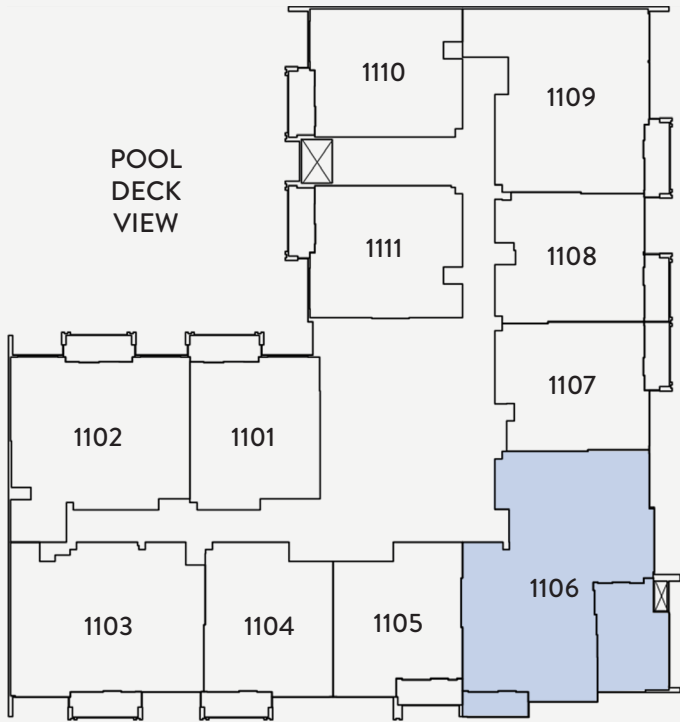

11<sup>TH</sup> FLOOR  
06

12<sup>TH</sup> FLOOR  
06

INTERNAL LIVING AREA - 1489.40 SQ. FT

OUTDOOR LIVING AREA - 375.12 SQ. FT

TOTAL LIVING AREA - 1864.52 SQ. FT













# THANKS FOR WATCHING

CONTACT US FOR MORE INFORMATION

 [www.svrealstate.agency](http://www.svrealstate.agency)

 [svrealstate\\_agency](https://t.me/svrealstate_agency)

 [svrealstate\\_agency](https://wa.me/svrealstate_agency)

 [svrealstate@agency](mailto:svrealstate@agency)

 +9 909 999 99 99